

FOODKING SERIES 9000

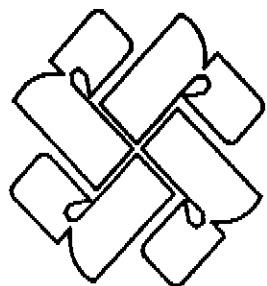

Polyvend[®]

SERVICE MANUAL

**WARRANTY
(LIMITED)**

Polyvend Inc. warrants this equipment to the ORIGINAL PURCHASER only, for a period of one(1) year from date of shipment to be free from significant defects in material or workmanship, three(3) years on electronic components and one(1) year on vending door solenoids and light ballast to the extent such parts are warranted to Polyvend Inc., except for starters, light bulbs and fuses, which will be warranted for two months from the date of shipment. The refrigeration system consisting of the compressor, fan motors, thermostat, starter, thermal overload, condenser coil, evaporator coil are warranted for a period of one(1) year to the extent those parts are warranted to Polyvend Inc.. Should a failure occur on the cooling system the unit is to be replaced and the defective unit returned to Polyvend. No refrigeration work is to be performed on a refrigeration unit. If such unit has been tampered with in any form the warranty on this unit is void.

Should any part prove defective within the warranted period, Polyvend Inc. will repair or replace(at its option) the defective component, but will not provide the labor, removal or reinstallation cost associated with such parts. All returned products or parts must be shipped freight prepaid to Polyvend and Polyvend will then prepay the shipping cost of the returned goods. Polyvend Inc. reserves the right to refuse any collect shipment. Any part returned under the terms of this warranty should be accompanied with a brief description of the defect or failure along with the model number and serial number.

This warranty applies only if the equipment is serviced and maintained in strict accordance with the instructions given in the Polyvend Service Manual that no unauthorized repair or disassembly has been done. Any defect caused by improper source of power supplied, abuse of the product, accident, alteration, vandalism, mineral build-up or improper cleaning or service techniques will not be covered by warranty.

Polyvend service or repair to items not in warranty will be subject to the standard service charge for repair of the failed components. For warranty or service information call or write to Polyvend Service Department.

**POLYVEND INC.
SERIES 900
FOOD KING**

The Polyvend Series 900 Cold Food Machine is a revolutionary new concept in vending equipment where bigger is not always better. It is designed to help the Operator increase his competitive position and to service locations where the need for a large cold food machine is not necessary, but the customer requires refrigerated food. With this machine a location can be provided with all types of refrigerated items in the smaller quantities keeping the out-of-date items to a minimum.

This machine comes equipped with nine shelves for cold food. These shelves can be setup with any combination of compartments from four(4) to twelve(12) and each "shelf" regardless of the number of compartments, is priced individually. The product delivery doors on the cold food side are locked by solenoids. When a vend is made the lock which allows the door to be opened is held open until the door is released. The shopper system allows the customer to select any available item. Pushing the Shopper Button on the front of the machine will allow the carousel to move 30 degrees or the equivalent of one small compartment. Pushing and holding the Shopper Button will allow the carousel to turn continuously. The shopper system will not operate when any one of the following conditions exist:

- 1) A product door is open
- 2) A vend is in progress

SPECIFICATIONS

HEIGHT.....72"
WIDTH.....29"
DEPTH.....34.5"
SHIPPING
WEIGHT.....approx..590LBS

VENDING COMPARTMENT SPECIFICATIONS

The cold food compartments are pie shaped and the following are the approximate straight line dimensions. Actual size of containers that will fit the pie shaped area are not considered.

Vertical Clearance: 4 3/8"
Front to Back Dimension: 8"
Front of pie(One corner to the other)

Compartments	Dimensions
12	4"
6	9 3/8"
4	16"

COLD FOOD CAPACITIES

The carousel trays can be configured from a maximum of 108 compartments(9 shelves with 12 compartments each) to a minimum of 27 compartments(9 shelves with 3 compartments each). The diagram below shows the standard configuration of our food machine as delivered.

ELECTRICAL SPECIFICATION

PRIMARY VOLTAGE.....	110VAC
SECONDARY VOLTAGE.....	24VAC
MAX. CURRENT.....	10AMP
VOLTAGE TO CHANGER.....	24V
VOLTAGE TO VALIDATOR.....	24V
VOLTAGE TO DOOR SOLENOIDS.....	24V

REFRIGERATION SPECIFICATIONS

COMPRESSOR.....	1/3HP
MAX.CURRENT OF COOLING SYSTEM.....	7 AMP
REFRIGERANT USED.....	R-134A

NOTE: Polyvend Inc. is not responsible for faulty or overloaded circuits within the facility where Polyvend machines are installed. The exact load imposed by the machine is stated above. The sum of all devices connected in to a particular circuit will determine the total line load. It is recommended that a separate electrical circuit be dedicated to these machines.

INSTALLATION

- * Remove all external packing material.
- * Inspect equipment for shipping damage, if evident file claim immediately with the carrier(See Shipping Procedures).
- * Remove keys from product dispensing compartment(in small manila envelope), unlock the service door and remove the shipping material.
- * Check the operation of the service door and locking mechanism. They should operate smoothly and latch at all three locking plates.
- * Make sure that the latch for the cold food door is functioning properly.
- * Place machine into position and adjust leveling legs so the machine is level and all the legs sit firmly on the floor.
- * It is extremely important to provide the machine with sufficient air flow for cooling. Provide a MINIMUM OF SIX(6) INCHES SPACING BETWEEN THE WALL AND THE BACK OF THE MACHINE.
- * Install coin mechanism and bill validator as required.
- * Plug service cord into 110 VAC source using the three prong grounded plug provided. If a grounded outlet is not available, use a proper external ground on all locations.

NOTE: In order to comply with electrical safety regulations and Underwriters Laboratories requirements, all electrical equipment must be properly polarized and grounded. The Polyvend machine is wired so that it is properly polarized in accordance with the electrical code. If the wall outlet is wired and grounded properly, then the vending machine will connect properly.

Shown in views A and B are two properly grounded and polarized wall outlets. One is a three wire grounded type wall outlet (See View A) and the other is a two wire wall outlet (See View B) with an adapter in place.

Should the polarity at the wall outlet appear any way other than that shown below, the outlet should be rewired by qualified personnel.

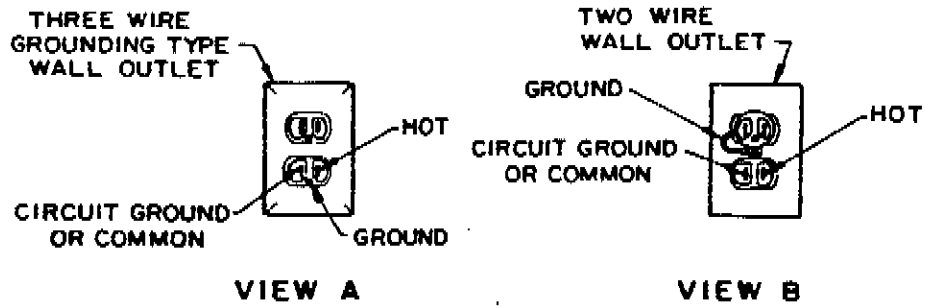

NOTE: Polyvend Inc. is not responsible for faulty or overloaded circuits within the facility where Polyvend machines are installed. The exact load imposed by the machines is stated in the electrical specifications section. The sum of all devices connected in to a particular circuit will determine the total line load. It is recommended that a separate electrical circuit be dedicated to these machines.

CAUTION: DISCONNECT POWER TO THE VENDING MACHINE BEFORE REMOVING THE CONTROL BOARD OR COIN CHANGER OR WORKING ON ANY ELECTRICAL COMPONENTS IN THE MACHINE.

* Test the coin mechanism and bill validator (if installed) to ensure smooth operation. If the operation of the coin mechanism is not smooth, check to make sure that you have proper alignment of the changer with the coin return lever.

* Load the coin tubes on the coin changer located on the front door of the machine. It is very important to fill the 25, 10 and 5 tubes for proper change pay back and operation of the bill validator (if installed).

NOTE: The maximum amount of change a Coinco 9302LF changer will hold is \$38.60, \$22.50 in quarters, \$12.00 in dimes and \$3.40 in nickles. The maximum amount of change that a Mars TRC-6010XV will hold is \$29.95, \$16.75 in quarters, \$9.80 in dimes and \$3.40 in nickles.

- * Place the price stickers just above the selection number for each selection located to the right of each vend door. Set the prices of the products. (See price setting). Note: A changer must be installed in this machine in order to set prices in this machine. It is not necessary to have a bill validator installed in this machine for prices to be set.
- * Operate each vending dispenser, using coins. Operation should be smooth.
- * In the large manila envelope is a sheet with the sticker "PLACE FOOD HERE". Peel each sticker off and place it on the delivery door guide. The position should be in the center of the compartment that the selection will vend from.
- * Load the machine with product (See section on product loading).
- * Check to make sure that the Vend Options are set to the desired settings. See section on Vend Options.
- * There is a blower system designed to keep condensation from forming on the delivery doors. The system directs warm air across the delivery doors from the right side. Make sure that the blow is operating properly.

COLD FOOD SETUP

REMOVING TRAY HALVES

The tray halves can be easily removed to change the divider configuration for loading or for cleaning. They are removed by the following procedures:

1. Stop the carousel so that the tray section stops near the light fixture on the right side. See figure below.

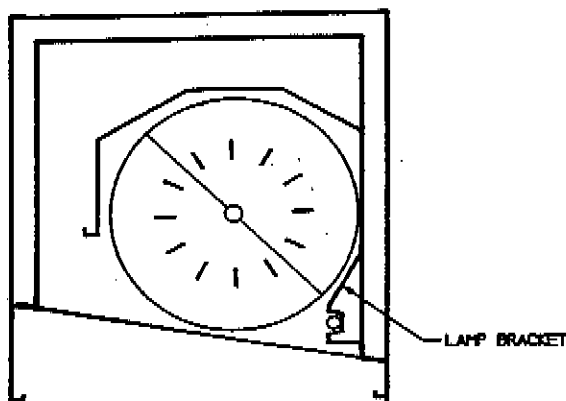

CAROUSEL POSITION TO REMOVE OR
INSTALL TRAY SECTIONS.

2. Underneath the center of the tray half is a leaf spring that is holding a stud attached to the tray. Pull down on the spring to release the stud and pull the tray outward towards you.
3. The rear of the tray is inserted into a groove in the collar that is attached to the tray column. A slight forward pressure may be required to disengage the rear of the tray from the groove.
4. The tray lips are designed with tabs that extend beyond the back edge of the tray. These tabs slip underneath the adjoining tray half to lock the two halves together and provide support for each other.
5. When the tray half is removed you will notice that the 12 and 6 compartment trays have a security top with clips that slip through the top and over the dividers. After changing the dividers or cleaning the tray replace the security tops and clips. These are required to keep the dividers from being bent sideways and allowing the food from being removed from the next compartment.

CAUTION: Always replace the security clips to prevent to much movement by the dividers.

CHANGING DIVIDER POSITION

Divider positions can only be changed while the tray half is removed from the machine.

- 1) Remove the security top by removing the screw that holds each security clip in place and then remove the security clip. Once the security clips are removed the security top can be lifted off the dividers.
- 2) Lift the rear of the divider first with a slight upward pressure. This allows the divider latch to slip out of the tray bottom. To replace the divider reverse this sequence of steps.
- 3) Replace the security top and clips. Tighten each screw that holds the clips in place. Tray half is now ready to be installed in the machine.

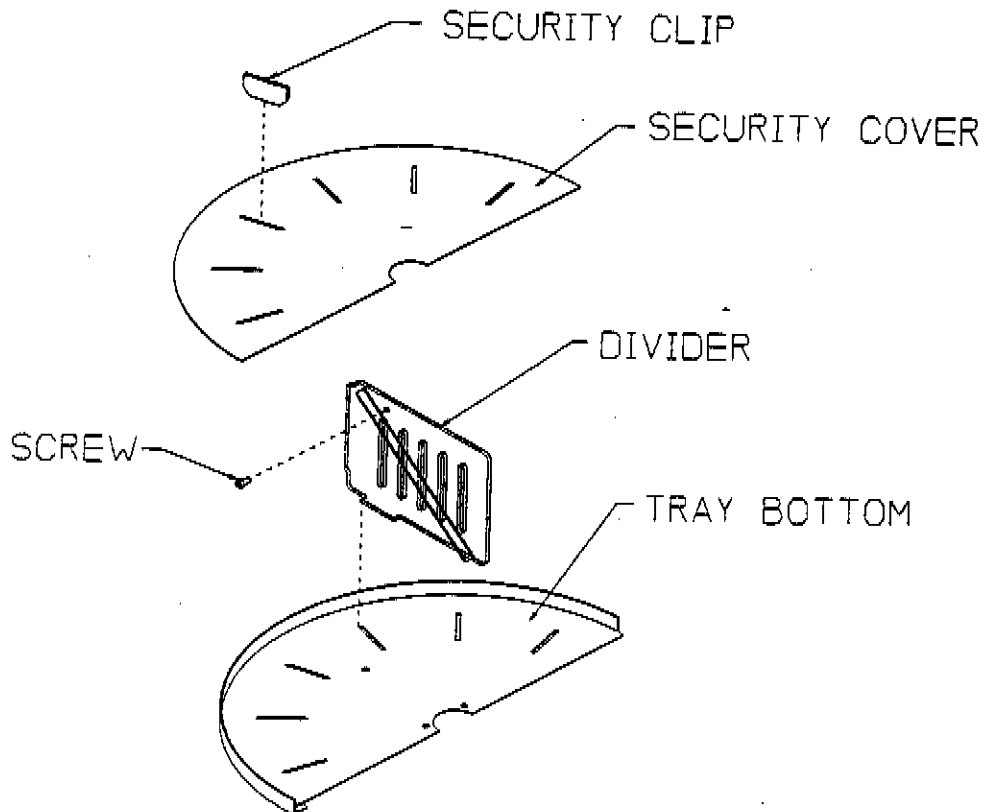

CAROUSEL JAM

- 1) Should a carousel jam, loosen the wing nut on the carousel drive motor assembly until you can remove the chain from the sprocket drive.
- 2) Then take hold of one of the carousel trays and try to back up the carousel to un-jam it. Remove the cause of the jam.
- 3) Install the chain on the sprocket drive but do not tighten the tension wing nut on the drive motor assembly.
- 4) Close the refrigerated door and check to make sure that the tray divider lines up with the right hand side of the vend door. If it does not line up loosen the wing nut on the drive motor assembly and move the chain over on the sprocket drive until the tray divider lines up with the right hand side of the vend door. After ensuring the proper alignment tighten the wing nut down. DO NOT over tighten the chain or the carousel motor may bind up.

SETTING THE HEALTH SAFETY

With the new control board the Health Safety is reset when the front door of the machine is opened then press mode button and go into the service mode. Continue to press the mode button a total of eight(8) times, until the control board returns to the sales mode(00 appears on display). Close the front door of machine and the health control timer will start immediately. The control board will after 30 minutes check the health safety to ensure the temperature in the cold food machine is below 45 degrees. During that 30 minute period the control board timer is running the cold food machine will vend products. When the route person comes to load the machine the health control will automatically reset when the door is closed. If there is a power failure or the health control turns the machine off it will be necessary to go back into the service mode and reset the health control.

If the temperature is above 45 degrees the machine will be taken out of service, the Make Alternate Selection light will be flashing and the machine will not accept any money. To check the operation of the health control, after 30 minutes press any selection number and if the price appears everything is working properly. If make Alternate Selection light is flashing the Food King 900 has been taken out of service.

INSTALLING PRICE TABS

The Food King 900 price tabs can be easily installed by simply slipping them into the proper slot located next to the selection number to the right of the vend door for each selection. Price tabs are provided in the large envelope packed in each machine.

To check that the pricing is correct, simply press the selection number for the respective selection to be checked and the price set in the control board will be displayed on the LED readout.

PRODUCT LOADING

To access the food compartment of your machine, you must;

- 1) First open the main door as far as possible.
- 2) Release the inside door latch with the handle of the cold food door and open.

The carousel can then be rotated to the left by a two(2) position service switch located in the upper right hand corner of the cold food box;

- 1) Push the switch in once and the carousel will move 30 degrees (1/12 of a rotation) for easy loading from top to bottom.
- 2) Pull the switch out and the carousel will rotate continuously for loading one shelf at a time.
- 3) Push the switch in will stop the rotation.
- 4) Close the cold food door and latch.

SOLENOID COVER PANEL REMOVAL

At some time it may be necessary to remove the cover over the solenoids for service or maintenance. To remove the cover open the front door of the machine. Then unlatch and open the inside cold food door. Located on the back side of the cold food door is the solenoid cover. Take hold of the solenoid cover at the top and bottom and lift up firmly on the panel. The panel should move upward about 1/2" allowing you to then remove the panel. Set the cover out of the way. To reinstall the cover reverse the process by repositioning the cover, making sure that all points are latching. Slide the cover downward about 1/2" inch. Make sure that the cover is securely latched in place. If one of the latches is missed the cover may rub on the carousel trays in that area. Close the front door and ensure that the cover is not rubbing against the carousel.

CHILLER ASSEMBLY REMOVAL

To remove the chiller assembly from the machine, unplug the cooling unit from the power box. On the left hand side of the chiller in the front area, in the bottom of the machine is the lever for lowering the cooling unit. Take hold of the lever and lift it up. The cooling unit will drop down in the front. Unplug the chiller and open the harness wire guide. You can then lift up on the unit and slide it out the front of the machine. To install the replacement unit slide the unit in with the thermostat facing you. Push down on the lever and the unit will rise up and seal the openings into the refrigeration area. Make sure that the cooling unit is lined up with the cabinet openings and that there is a good seal around the outlet not allowing cold air to escape. plug in the service power cord and loop the power cord so it can not get caught under the cooling unit.

NOTE: There should be a foam gasket around both openings on the top of the chiller to seal the unit to the bottom of the cabinet when installed. It may be necessary to put talcum powder on both gaskets to allow them to slide into place without hanging up.

ELECTRICAL SERVICE SECTION

MODES OF OPERATION

The system will operate in one of two modes, sales or service. On power up(after completing configuration), the machine is in the sales mode. Service mode may be selected by pressing the mode switch mounted on the control board. The system will return to the sales mode if the mode switch is pressed again or after 25 seconds of no service mode activity.

SALES MODE

In the sales mode, the control board will control the dispensing of products according to customer credit and selection inputs. The control board will communicate with the coin mechanism and dollar bill validator(if installed); so, as credit is entered it will be shown on the display. If there is inadequate change available, the coin mechanism will indicate that an exact change situation exists and the control board will illuminate the Exact Change light located just below the display.

When a customer makes an H selection and (within 5 seconds) presses numbers 0 thru 9, the accumulate credit will be compared to the price set for this selection and if the credit is equal to or exceeds the set price, the corresponding solenoid will be energized. If the vend is successful, the price will be deducted from the credit value and the change returned.

The vend will be considered unsuccessful if the vend solenoid does not receive sufficient current or fails to close within 12 seconds. The vend will not be attempted if the solenoid has already been detected as failed or if the selection made is not in the configuration of the machine. In any case, credit will not be deducted and the Make Alternate Selection light will flash, until another selection is made.

If there is insufficient credit for the selection made, the price of that selection will be displayed for five(5) seconds, indicating additional money needs to be inserted. The person must either make another selection or enough credit is added. The price of the selection will be displayed during the vend.

If power should fail during a vend, the credit will be lost and the selected solenoid will drop back into the locked position. When power returns, the solenoid will NOT re-energize.

SERVICE MODE

The service mode can be entered by pressing the "MODE SWITCH" located on the control board on the right hand side. By pressing the mode button you will step through the different modes of the control board.

DETAILED OPERATION OF CONTROL BOARD

At the time of delivery from Polyvend Inc., the control board will be set as follows:

1. All vend options will be off.
2. The cash accountability will be set to \$00,000.00. Note: Due to factory testing the total will not be exactly \$00,000.00.
3. The total number of vends will be set to 00000.
4. All prices will be set to \$00.50.

COIN DISPENSING

Press the service mode switch one(1) time and Ser1 will appear on the digital display. Press selection button #1 nickels will be dispensed out of the changer. Press button #2 to dispense dimes and selection button #3 to dispense quarters.

PRICE SETTING

Press the service mode switch two(2) times and Ser2 will appear on the digital display. Press the selection button you wish to change the price of. Release the button and press it again and the price will go up in nickel increments. If you go past the price release the selection button and press it again. To set the price of the next selection, press the selection number and repeat the price setting process. To return to the sales mode after setting all of the prices, press the mode switch 6 times.

SERVICE VEND

To service vend a selection press the mode switch three(3) times. The digital display will show Ser3. Press the selection number of vend solenoid you wish to test. The solenoid should release and the vend door allowed to be opened. To test vend a second solenoid press the selection button for that selection and the solenoid will release allowing you to open the vend door. To return to the sales mode press the mode switch five times.

ACCOUNTABILITY SYSTEM

To display the stored accountability press the mode switch four(4) times. The digital display will show Ser4. For total cash accountability press selection button #1 and the total amount of money the machine has taken in will be shown. To display the total number of vends for the machine press selection button #2 to display the total vends by the machine. To return to the sales mode press the mode switch four times.

CASH ACCOUNTABILITY BY SELECTION

To display the stored accountability press the mode switch five(5) times. The digital display will show Ser5. For the total cash accountability for an individual selection press the selection number you wish to check. The total sales for that selection will be displayed. To check an additional selection press the selection number and the total cash accountability will be displayed. To return to the sales mode press the mode switch three times.

TOTAL VENDS BY SELECTION

To display the total number of vends by selection press the mode button six(6) times. The digital display will show Ser6. For the total number of vends of a selection press the selection number. The total number of vends for that selection will be displayed. To check another selection press the selection number of the selection you wish to check. To return to the sales mode press the mode switch two times.

VEND OPTIONS

To enable or disable the vend option, press the mode switch seven(7) times. The digital display will show Ser7. Press selection button #1 to check the status of the Forced Vend feature. To change the status of this feature press selection button #1 and the feature will be changed(Example feature is "on" it will then be turned "off"). Press selection button #2 for the status of the Multi-vend. To change the status of this feature press selection button #2 and the feature will be changed. To return to the sale mode press the mode switch one time.

ERROR CODES

Er = 1 A door is open.
Er = 2 High Temp error.

HEALTH CONTROL RESET

This machine has a high temperature sensor called a health control. Should the temperature inside the refrigerated area be above 45 degrees the health control will shut down the machine and the indicator light will flash indicating "Make Alternate Selection"

To reset the health control open the front door of the machine and press the mode button eight(8) times. Then close the front door of the machine, starting the health control timer. After 30 minutes have elapsed the control board will check the health control(products will be vended during the 30 minutes time period) and if the temperature is above 45 degrees the unit will be taken out of service. If the temperature is below 45 degrees the unit will operate normally and vend from any selection. When a route person comes to fill the machine when they open and close the front door of the machine the health control will automatically be reset. Should there be a power failure or the cooling system fail it will be necessary to reset the health control before the unit will operate properly.

HIGH VOLTAGE POWER SUPPLY

The high voltage power supply is located in the bottom of the machine on the left side in the front area. The unit has circuit breakers which provide 110 volts, 24 volts and 10.8 volts to the machine. The circuit breakers function is from left to right first breaker to the left is to provide 24 volts to the control board. The second circuit breaker provides 10.8 volts for the control board. The third circuit breaker provides 24 volt for the carousel drive assembly. The fourth circuit breaker from the left provides 110 volts to the light assembly. The circuit breaker located on the far right is the circuit breaker for 110 volts for the entire machine. Located inside of the power box is the ballast for the florescent light, the step down transformer and the RFI filter.

CLEANING AND MAINTENANCE INSTRUCTIONS

A. PAINTED SURFACES

All painted surfaces and the vinyl covered product delivery door can be cleaned with a clean cloth any common brand of household detergent. Do not use harsh abrasive materials on these surfaces, they will scratch the paint or vinyl.

B. VEND DOORS

The vend doors can be cleaned with any common brand of window cleaner and a soft cloth. DO NOT USE harsh abrasive cleaners on the sign. Never use paper products to clean the vend doors.

DO NOT USE ANY KIND OF SOLVENT ON THE DOOR SIGN. Solvents will cause the vend doors to cloud up. Use a soft cloth to clean the door. Do not use paper products on the sign. They will cause scratches.

C. Clean the condenser area on the rear of the machine .

D. Lubricate the following components every six months with white grease, grade 2 high/low temperature grease or equivalent, the top outer-door hinge, bottom outer-door hinge, door locking plates and inner door hinges.

COLD FOOD SANITATION

The following are the general cleaning procedures for the cold food area. It is recommended that the local health inspector be consulted for full requirements of sanitation on cold food machines.

- 1) All surfaces that come into direct contact with food must be cleaned with warm water and mild detergent at all regular service intervals.
- 2) After cleaning food contact surfaces rinse with clean, potable water.
- 3) Sanitize food contact surfaces with a good grade chemical sanitizing solution(chlorine, iodophore, etc.).
- 4) Allow all food contact surfaces to air dry.

POLYVEND SHIPPING POLICY

The following information is to assist you in assuring safe delivery of your merchandise and in expediting of freight damage claims.

Our terms of sale are F.O.B. our factory. The responsibility for damage in transit is the carrier's whether it be visible or concealed damage. We have taken every precaution to ensure safe arrival of this equipment, but our responsibility ceases the moment the shipment is turned over to the carrier.

Acceptance of this shipment by the carrier is an acknowledgement that the equipment was delivered to them in good condition and properly packed. The carrier who delivers this merchandise to your door is responsible for its safe delivery.

PROCEDURE FOR VISIBLE DAMAGE

1. IT IS VERY IMPORTANT TO INSPECT ALL FREIGHT DELIVERIES, WHETHER MACHINES OR PARTS, IMMEDIATELY. If there is any visible damage you have the right to either refuse the merchandise or accept the damaged shipment. If you accept it, make certain that you have the delivery personnel note the nature and extent of damage on the freight bill.

2. After you determine the extent and cost of the damage, notify the delivering carrier's office by phone and confirm with a written notice within 15 days requesting an inspection of the damaged merchandise. Keep a copy of the inspection request for claim purposes. Do not destroy the packing material until shipment is inspected and claim is settled.

3. When the inspector arrives, ask for a claim form. In filing a claim, you may make a cash settlement with the carrier for the full invoice price of the merchandise or contact Polyvend Inc. at 1-501-327-1301 and make arrangements to have merchandise returned for repair and file a claim for repair charges. Do not return "DEADHEAD". Do not claim more than the cash price of the machine, plus freight.

SHOCK WATCH PROCEDURES

On each machine shipped out of Polyvend Inc., there is an indicator called a Shock Watch, which will turn from white to red if the machine has received a sever impact. The shock watch is a red hexagon shaped label mounted on the front glass of the machine. Just above the shock watch will be a label on the outside of the machine with instructions on what to do when the machine is received and what to do if the shock watch has changed color from white to red.

Inspect the shock watch "IMMEDIATELY" upon receipt of the machine. DO NOT SIGN THE BILL OF LADING until you have inspected the shock watch to see if it has turned from white to red. If the shock watch has turned red note this on the bill of lading. Inspect the machine "IMMEDIATELY" for damage both on the exterior and interior of the machine, if damage is found follow the procedures for concealed damage.

PROCEDURE FOR CONCEALED DAMAGE

1. If there is no visible damage, YOU MUST OPEN THE SHIPMENT WITHIN 15 DAYS AND INSPECT FOR CONCEALED DAMAGE. If there is concealed damage, notify the delivering carrier by phone immediately asking for an inspection. Confirm the request in writing and keep a copy for claim purposes. If you fail to notify the carrier within 15 days of delivery, by telephone and in writing the freight company is no longer liable for damage and will probably refuse your claim. Do not destroy packing material until shipment is inspected and claim is settled.

2. After inspection by the carrier, file a claim for damages at once. On concealed damage, unless it can be proven that the carrier is responsible for the damage, they will probably want to settle on a compromise basis. Therefore, the faster you inspect your delivery and notify the carrier, the better the chances for full settlement. If the claim is disallowed, check on the possibility of a compromise.

PROCEDURE FOR SHORTAGES

1. If the shipment delivered to you is not in accordance with the quantity of cartons shown on your receipt, do not accept it until shortages are noted on the Freight Bill or Bill of Lading and signed by the truck driver. Failure to do this releases the carrier from any responsibility,

2. If the shorted item is not delivered within a reasonable time, file a claim with the delivering carrier for the invoice or cash price of that item.

NOTE: Claims for loss or damage will NOT BE DEDUCTED FROM YOUR INVOICE while you wait adjustment of such claims.

DRAWINGS AND PARTS LISTS

SERVICE DOOR TRIM ASSEMBLY
PARTS LIST

ITEM	DESCRIPTION	PART NO.	QTY
1	TOP TRIM PANEL	097-4094	1
2	LEFT SIDE TRIM PANEL	097-4091	1
3	RIGHT SIDE TRIM PANEL	097-4093	1
4	BOTTOM TRIM PANEL	097-4092	1
5	HORIZONTAL SERVICE DOOR TRIM	097-2006	4
6	VERTICAL SERVICE DOOR TRIM OUTER	097-2005	2
7	VERTICAL SERVICE DOOR TRIM INNER	097-2004	2
8	TOP/BOTTOM CONTROL PANEL TRIM	098-4317	2
9	LEFT/RIGHT CONTROL PANEL TRIM	098-4320	2
10	SET - COLD FOOD BUTTONS	097-8014	1
11	COIN RETURN PIN ASSEMBLY	099-6010	1
12	COIN INLET	17930	1
13	BEZEL DECAL	097-8010	1
14	COIN RETURN FRONT	001-2003	1
15	SERVICE DOOR BLACK LOCK	14325BLK	1

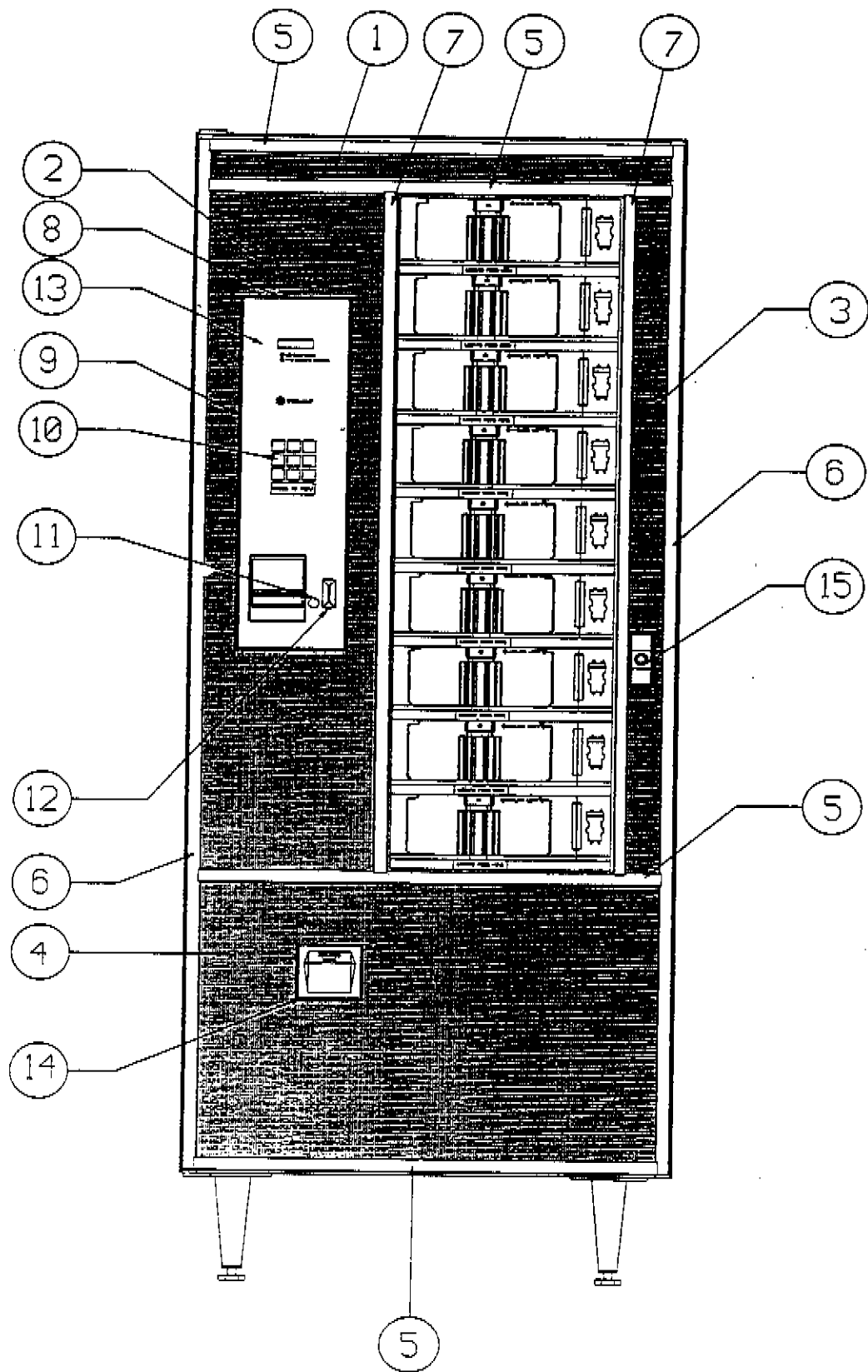

SERVICE DOOR ASSEMBLY
PARTS LIST

ITEM	DESCRIPTION	PART NO.	QTY
1	W/A SERVICE DOOR	097-5006	1
2	HINGE ASSEMBLY	097-5009	1
3	NUT 1/4-20	N20C2520	4
4	W/A SHADOW BOX	097-5006	1
5	SCREW #8-18 X 3/8	b9C818-6	48
6	LOCK BAR ASSEMBLY	097-5045	1
7	LOCKING LEVER ASSEMBLY DRIVE CAM/LIFT	097-5102	1
8	BLOWER MOUNT ASSEMBLY	098-5217	1
9	SHADOW BOX FAN	097-8004	1
10	MOTOR COVER	098-4331	1
11	SCREW #8-18 X 3/8	01298BLK	2
12	DOOR SUPPORT ROLLER ASSEMBLY	150-5244	1
13	SCREW 1/4-20 X 1/2	b20C2520-8	2
14	COIN RETURN CUP ASSEMBLY	001-5132	1
15	SCREW #6-32 X 1/4	b20c632-4	4
16	DOOR STOP CABLE ASSEMBLY	098-5091	1
17	SCREW, HEX, WASHER HEAD	b16C818-8	4
18	STRIKER SWITCH	097-4125	1
19	SCREW #8-32 X 3/8	01715	2
20	CASH BOX ASSEMBLY	210-5080	1
21	DOOR BUMPER	097-8032	1
22	KEYPAD BACKING PLATE	097-4088	1
23	HEX NUT W/LOCK WASHER	20208	27
24	CHANGER PLUG ASSEMBLY	098-5264	1
25	W/A COIN CHUTE	098-5274	1
26	COIN RETURN CHUTE ASSEMBLY	220-5095	1
27	ELECTRONIC COVER	097-4127	1
28	COIN RETURN ARM ASSEMBLY	098-5041	1
29	W/A CASH BOX RETAINER	200-5016	1
30	WIRE CLAMP	400-8056	4
31	CONTROL BOARD	097-8005	1
32	BRACKET DEX/UCS JACK	097-4138	1
33	DEX/UCS JACK	098-8135	1
34	INSTRUCTION DECAL	098-8020	1
35	SCREW #6-32 X 1/4	S20C632-4	4
36	SCREW #6-32 X 3/4	S20C632-12	4

TO BE USED IN CONJUNCTION WITH PAGES 27 AND 28

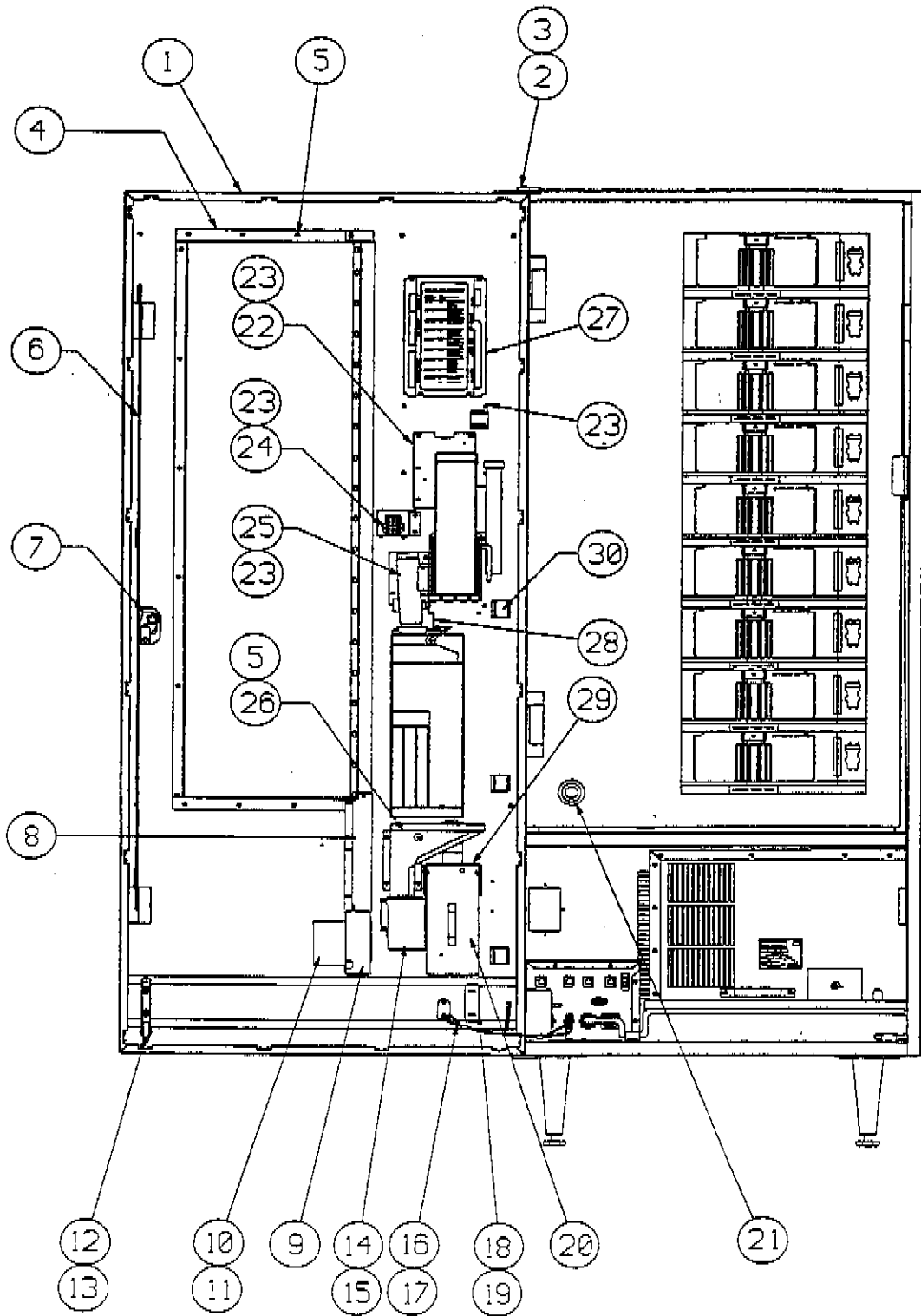

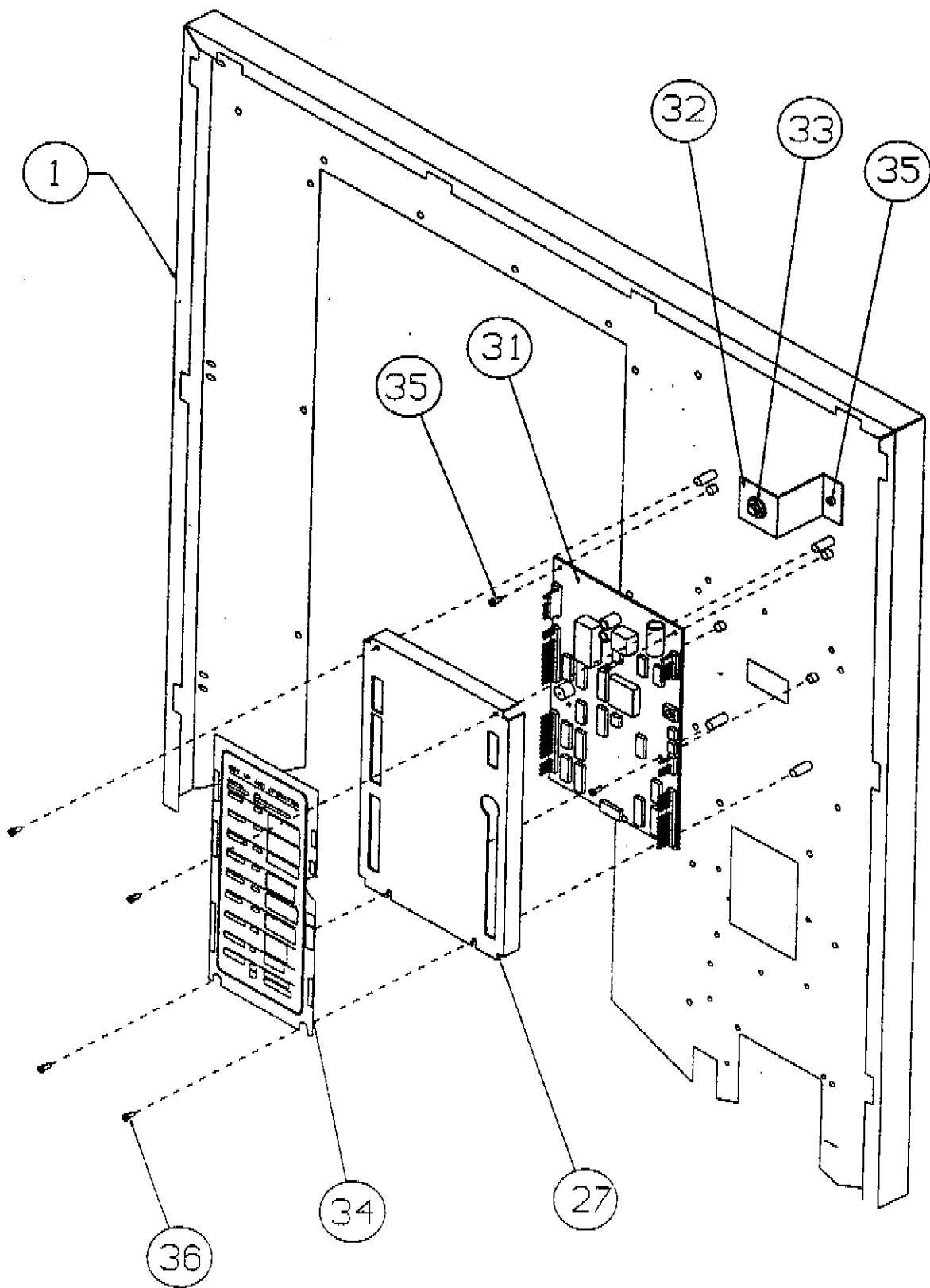

SHADOW BOX ASSEMBLY
PARTS LIST

ITEM	DESCRIPTION	PART NO.	QTY
1	W/A SHADOW BOX	097-5066	1
2	BLOWER MOUNT ASSEMBLY	098-5217	1
3	SHADOW BOX FAN	097-8004	1
4	BLOWER FAN GUARD	098-8162	1
5	MOTOR COVER	098-4331	1
6	SCREW #8-18 X 3/8	S39C818-6	20
7	SCREW #8-18 X 3/8	01298BLK	2

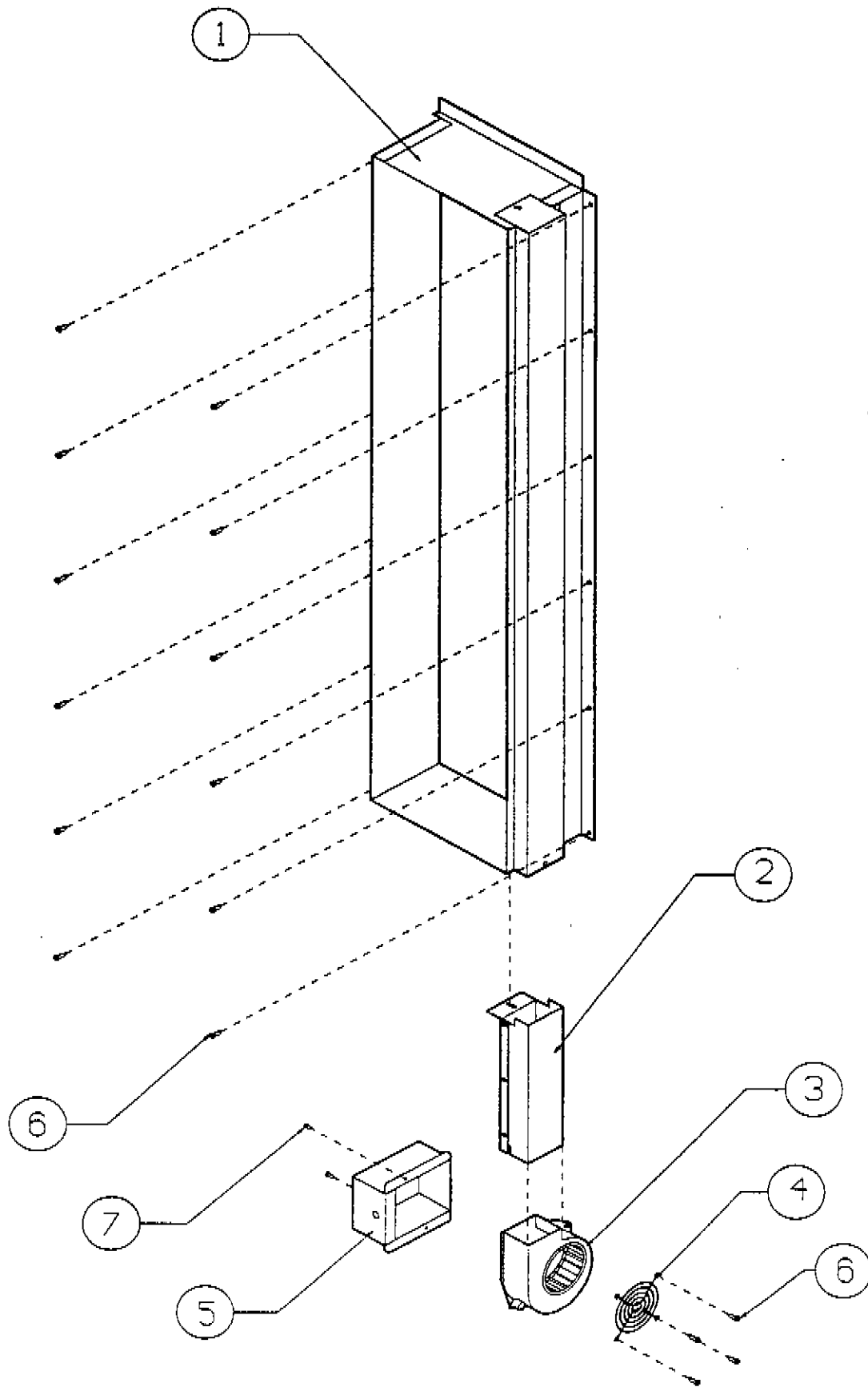

COIN RETURN ASSEMBLY
PARTS LIST

ITEM	DESCRIPTION	PART NO.	QTY
1	W/A COIN CHUTE	098-5274	1
2	NUT, HEX-LOCKWASHER #8-32	20208	2
3	COIN RETURN ARM ASSEMBLY	098-5041	1
4	TENSION SPRING	150-7003	1
5	COIN RETURN CHUTE ASSEMBLY	220-5095	1
6	SCREW #8-18 X 3/8	S39C818-6	4
7	RETURN CUP PIN	001-6122	1
8	E-RING 1/8	R10L125	2
9	COIN RETURN DOOR BLACK	001-2004	1
10	COIN RETURN CUP ASSEMBLY	001-5132	1
11	SCREW #6-32	S20C632-4	4
12	COIN RETURN FRONT	001-2003	1
13	1/4" E-RING	R10L250	1

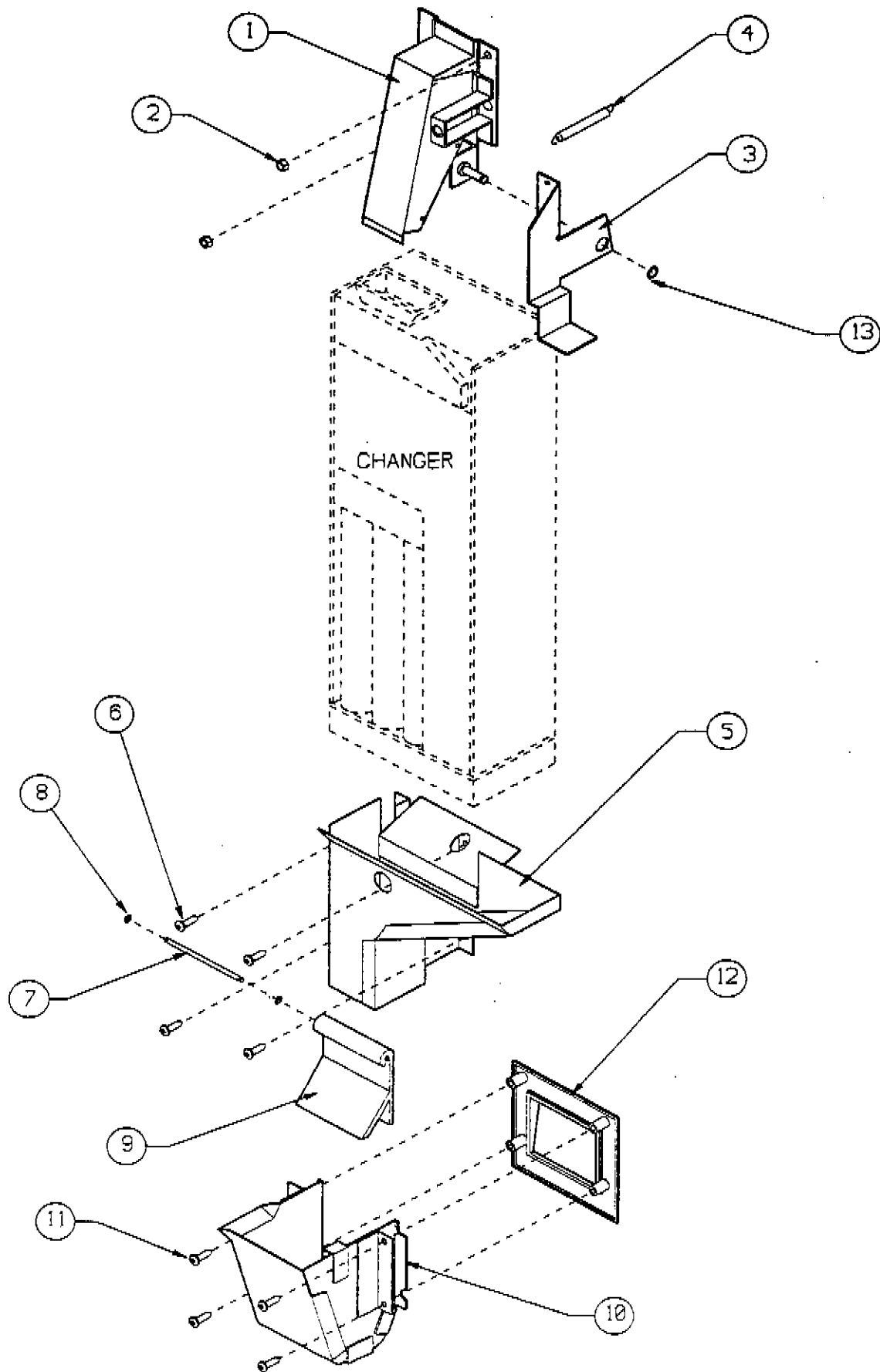

COLD FOOD LAMP ASSEMBLY
PARTS LIST

ITEM	DESCRIPTION	PARTS NO.	QTY
1	INNER GUARD ASSEMBLY	097-5114	1
2	LAMP END BRACKET	097-4000	4
3	UPPER ASSEMBLY BRACKET	097-5090	2
4	LOWER SOCKET ASSEMBLY	097-5089	2
5	SCREW #8-18 X 3/8	S39C818-6	8
6	VINYL CAP	20952WHT	4
7	CLEAR POLYCARBONATE TUBE	20951	2
8	FLUORESCENT LAMP	18845	2
9	LAMP FEED HARNESS	097-5088	1

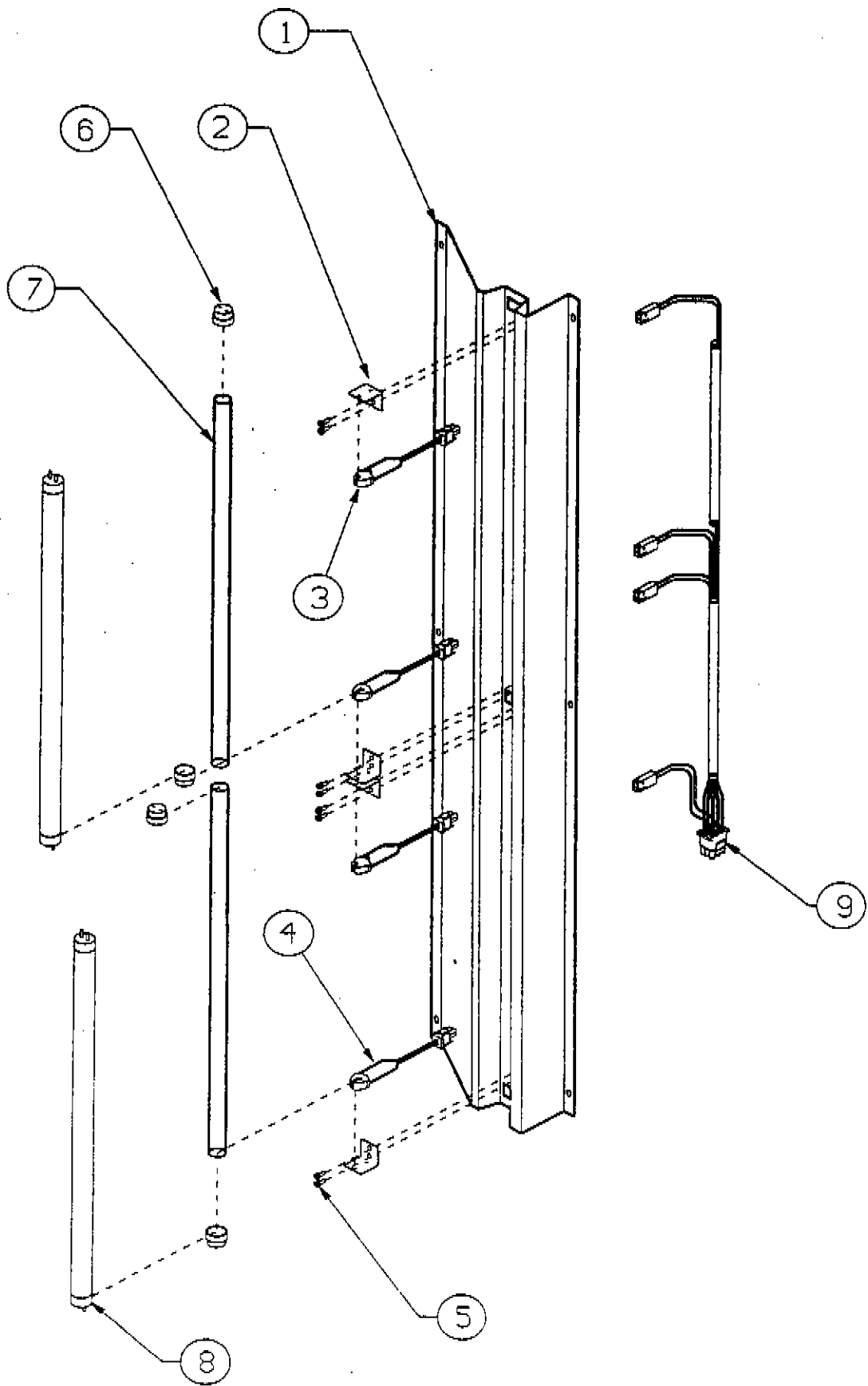

CAROUSEL ASSEMBLY
PARTS LIST

ITEM	DESCRIPTION	PART NO.	QTY
1	TRAY SUPPORT ASSEMBLY	098-5278	1
2	TRAY SEGMENT FINAL ASSEMBLY	097-5027	18
3	TRAY SUPPORT DIVIDER	098-2003	18
4	TOP TRAY ASSEMBLY SEGMENT	097-5025	2
5	TRAY DIVIDER	097-9010	66
6	W/A BASE PLATE	098-5277	2
7	THRUST WASHER	098-8156	2
8	NEEDLE ROLLER BEARING	098-8157	1
9	SLOTTED SCREW TRUSS HD	S39C818-10	8
10	SCREW	S15C632-48	31
11	3/8 PITCH CHAIN	097-8027	1
12	3/8 PITCH CHAIN REPAIR LINK	098-8054	1
13	HOLDER	098-4115	66

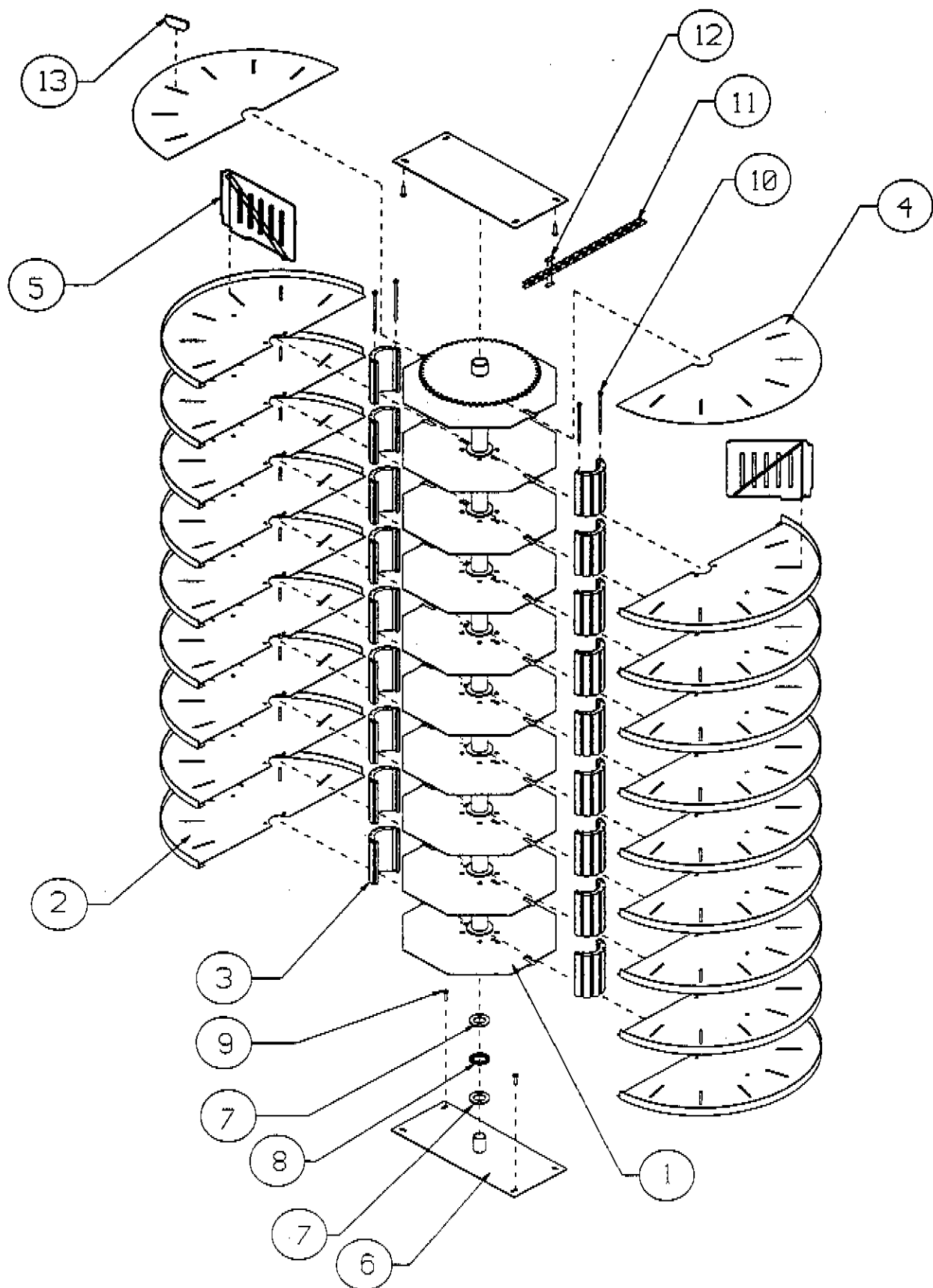

CHILLER INSTALLATION
PARTS LIST

ITEM	DESCRIPTION	PART NO.	QTY
1	CABINET ASSEMBLY	097-5014	1
2	COLD FOOD BOX ASSEMBLY	097-5020	1
3	GRILL WELD ASSEMBLY	097-5108	1
4	CHILLER ASSEMBLY	23504115	1
5	W/A RACK	097-5107	1
6	CHILLER LIFT LEVER	098-8015	1
7	LEVER CLAMP	23612	2
8	SCREW	S41C832-8	4

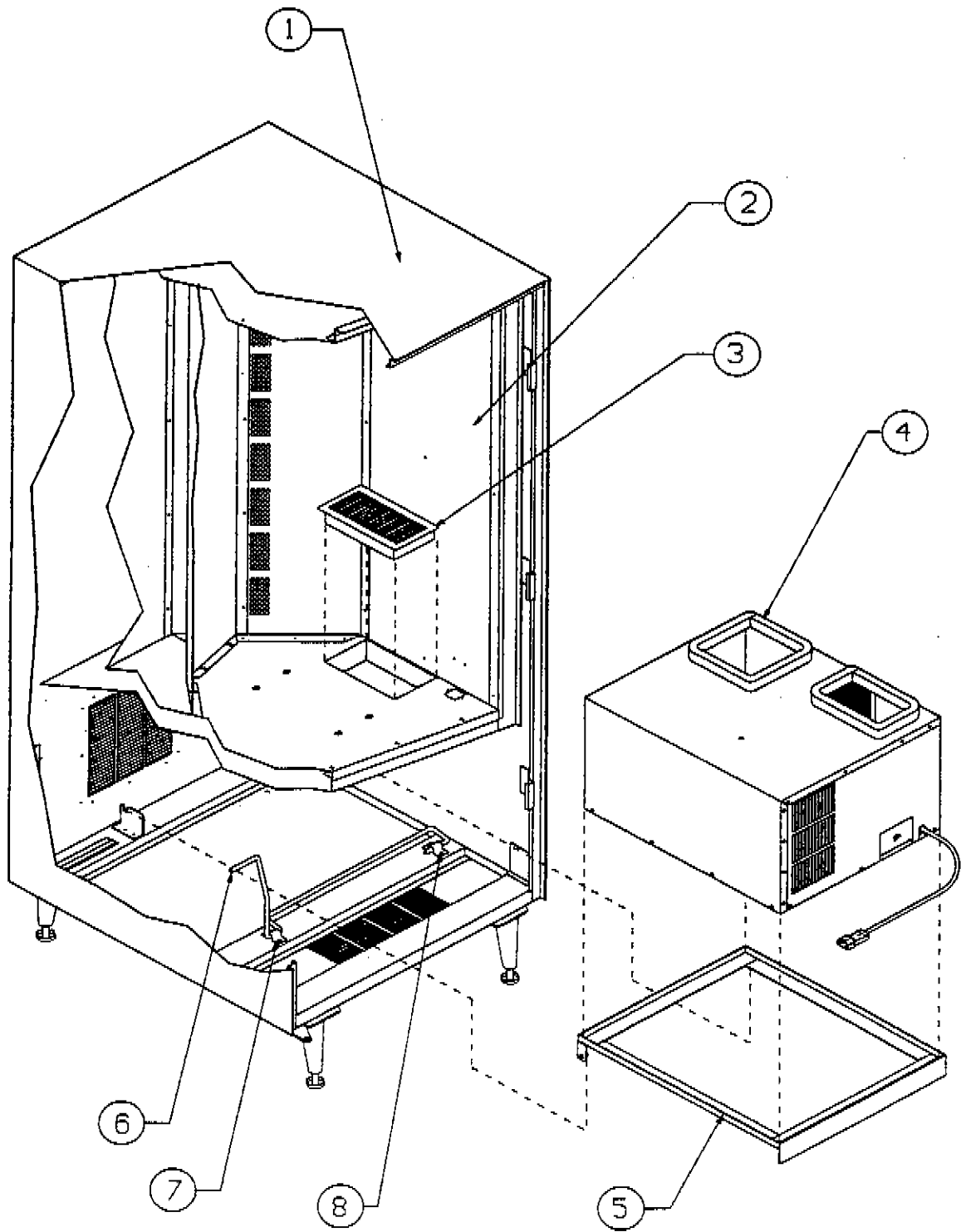

SERVICE DOOR SWITCH
PARTS LIST

ITEM	DESCRIPTION	PART NO.	QTY
1	SWITCH BRACKET	097-4124	1
2	DOOR SWITCH	099-8037	1
3	PULL TO CHEAT SWITCH	19746	1
4	SCREW #8-18 X 3/8	S39C818-6	2

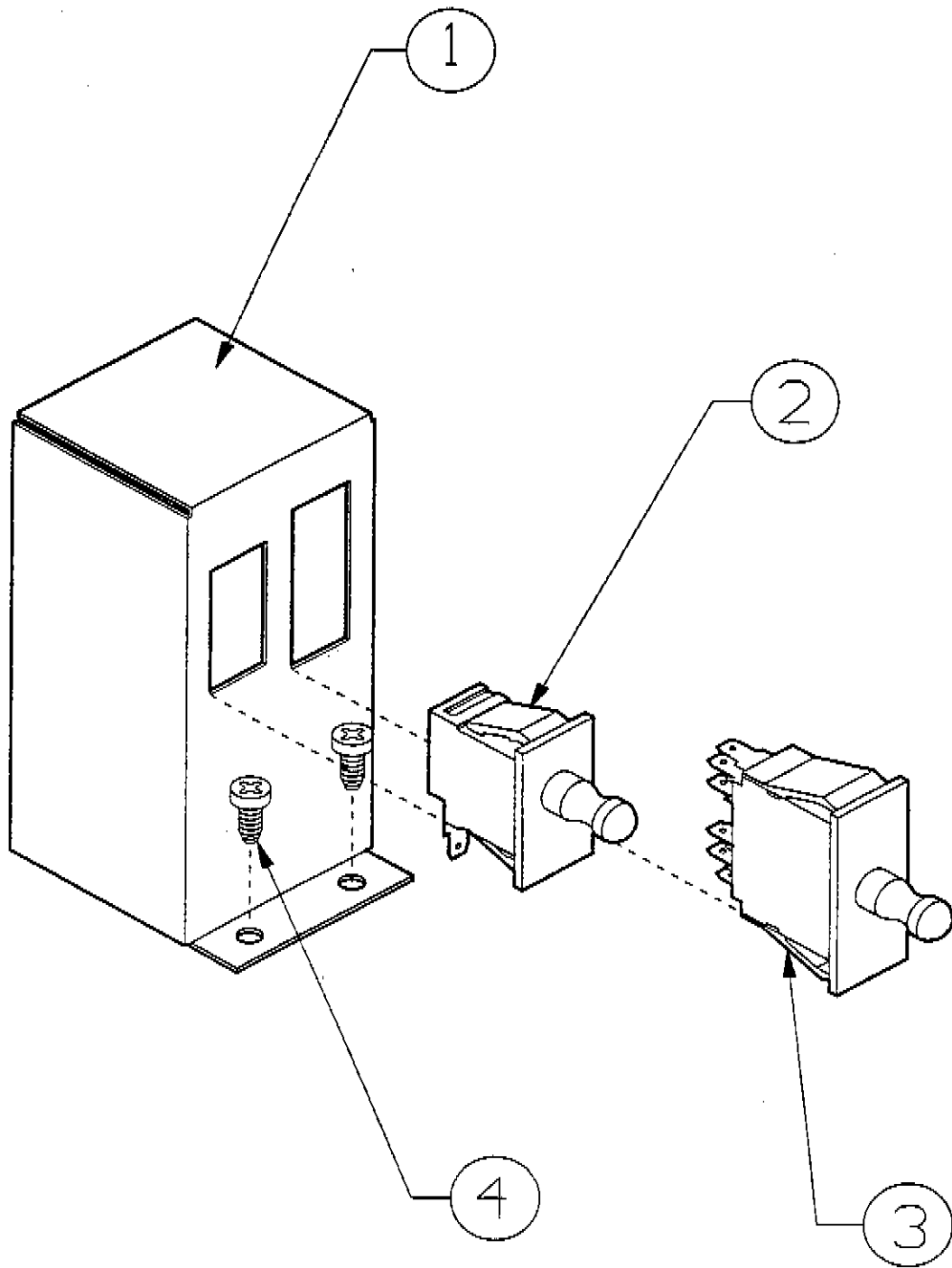

**DOOR SWITCH ASSEMBLY
PARTS LIST**

ITEM	DESCRIPTION	PART NO.	QTY
1	SWITCH MOUNTING BRACKET	098-4154	1
2	SWITCH MOUNTING COVER	098-4155	1
3	DOOR SWITCH	099-8037	1
4	SCREW #8-18 X 3/8	S39C818-6	2
5	SCREW #6-20 X 3/8	S40C620-6	2

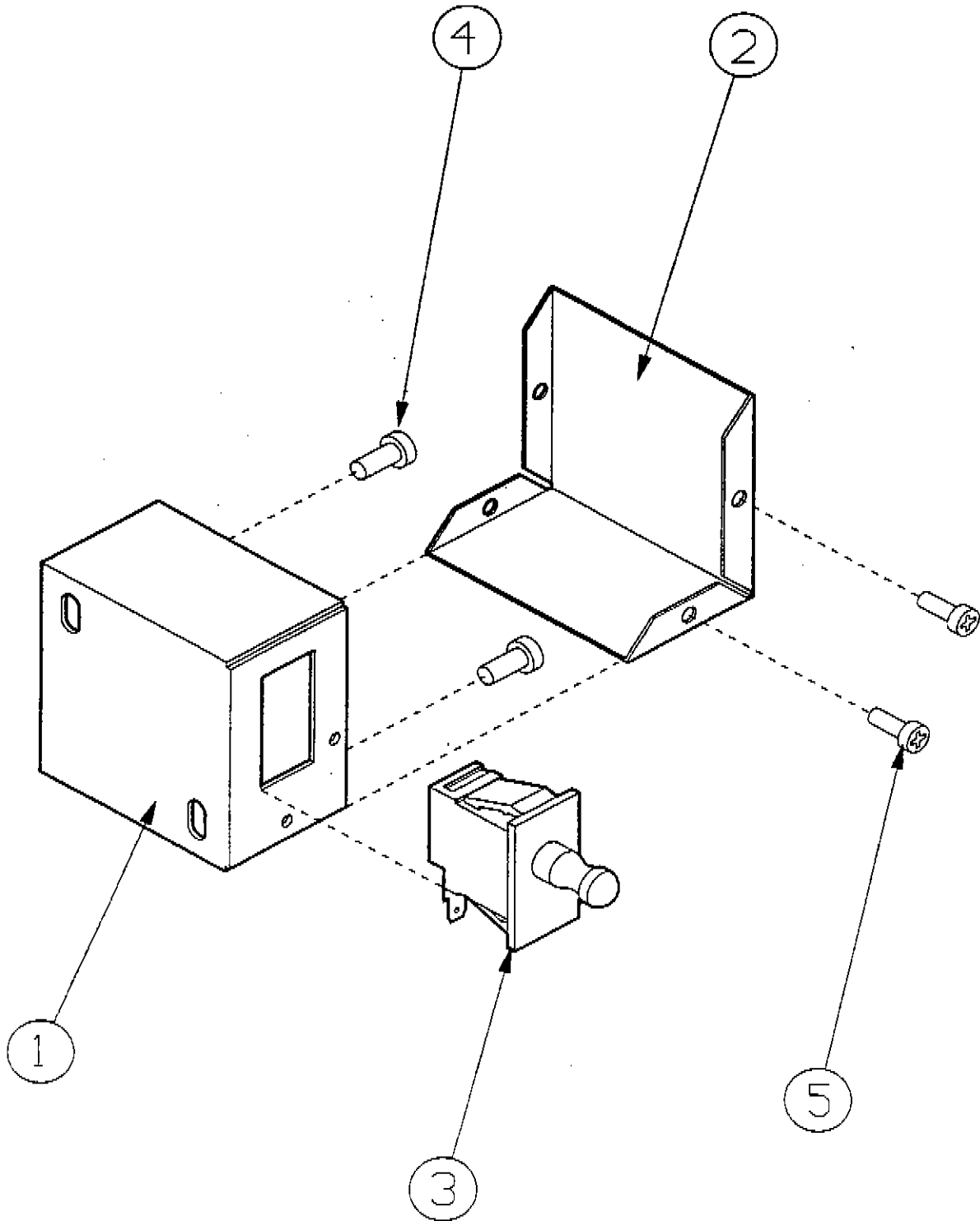

**COLD FOOD CABINET
PARTS LIST**

ITEM	DESCRIPTION	PART NO.	QTY
1	CABINET ASSEMBLY	097-5014	1
2	COLD AIR CHAMBER	097-4057	1
3	COLD FOOD BOX AIR BAFFLE	097-4058	1
4	LAMP BRACKET ASSEMBLY	097-5116	1
5	SCREW HEX HEAD STAINLESS #8 X 1/2	S160818-8	36
6	DIGITAL THERMOMETER	098-8129	1
7	THERMOMETER BRACKET	097-4135	1
8	CLAMP	098-8144	5
9	WIRE CLAMP	400-8056	1
10	AIR INTAKE SCREEN	098-4363	1
11	SCREW #8-18 X 3/8 BLACK	01298BLK	2
12	POWER BOX ASSEMBLY	097-5070	1
13	HEALTH SAFETY SWITCH	098-8015	1
14	INSECT SCREEN	098-8063	1
15	SCREW #8-18 X 3/8 STAINLESS	S39D818-6	12

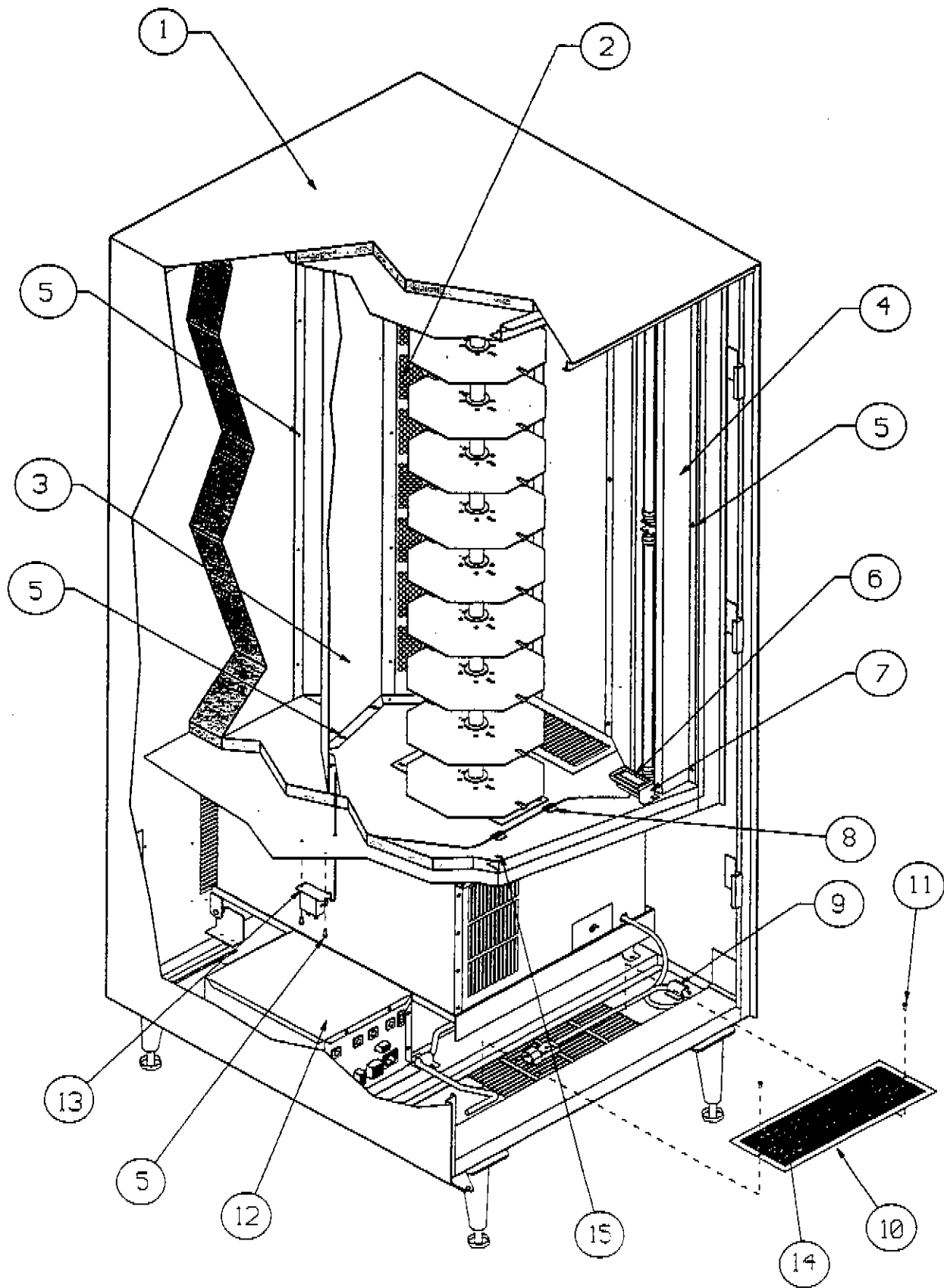

KEYPAD ASSEMBLY
PARTS LIST

ITEM	DESCRIPTION	PART NO.	QTY
1	KEYPAD BACKING PLATE	097-4088	1
2	NUT W/LOCKWASHER #8-32	20208	6
3	KEYPAD COLD FOOD	097-8009	1
4	KEYPAD SHIM	097-4089	2
5	KEYPAD SPACER	097-8136	1
6	BUTTON SET	097-8014	1
6A	PUSH TO VIEW BUTTON	23467	1

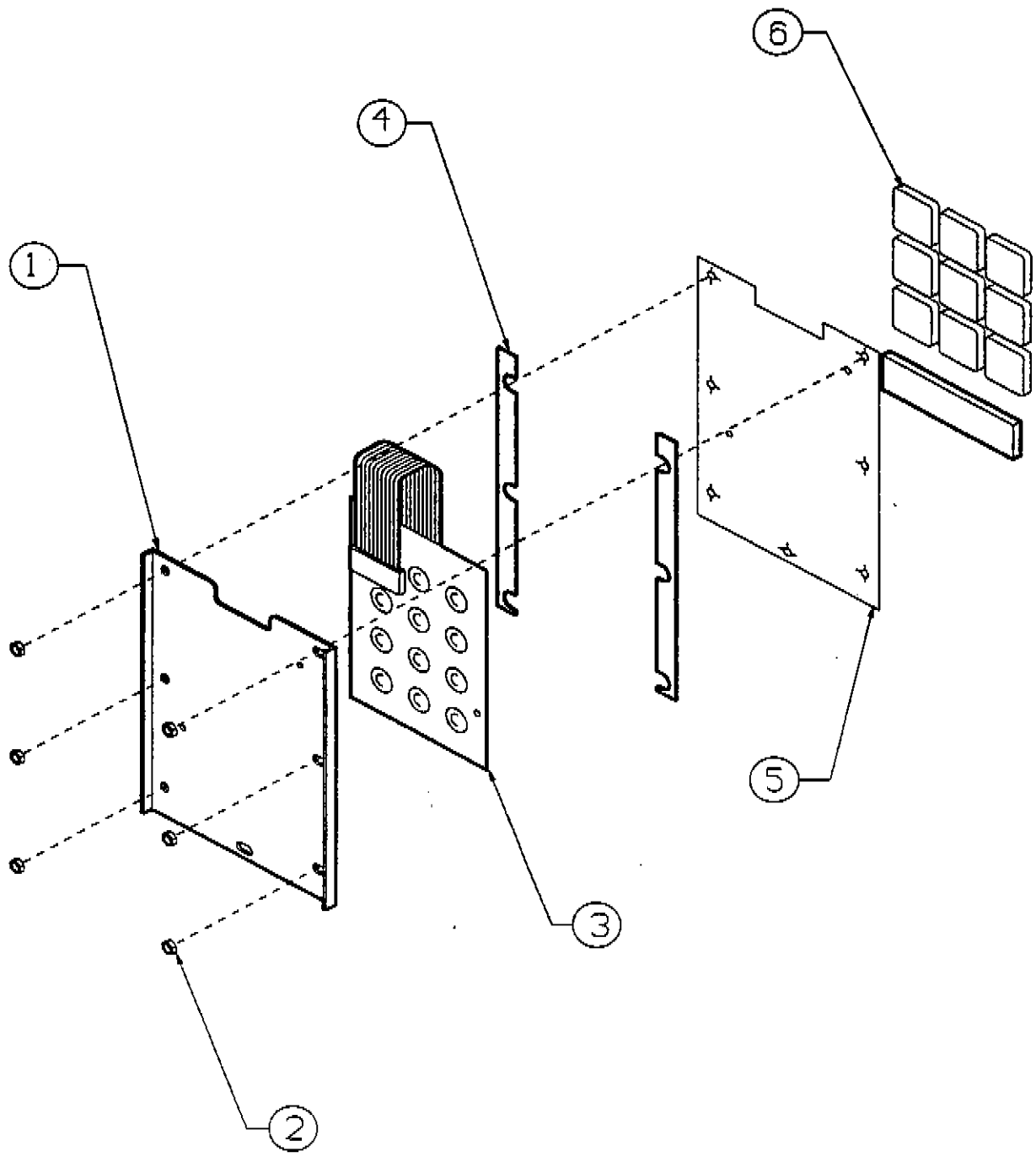

CABINET BACK
PARTS LIST

ITEM	DESCRIPTION	PART NO.	QTY
1	CAUTION LABEL POWER CORD	097-8028	1
2	SLAVE MACHINE CORD COVER	099-4168	1
3	SCREEN RETAINER VERTICAL	098-437503	2
4	SCREEN RETAINER HORIZONTAL	098-437502	2
5	EXHAUST SCREEN	098-4365	1
6	SCREW #8-18 X 3/8	01298BLK	12
7	POWER CORD	097-5071	1

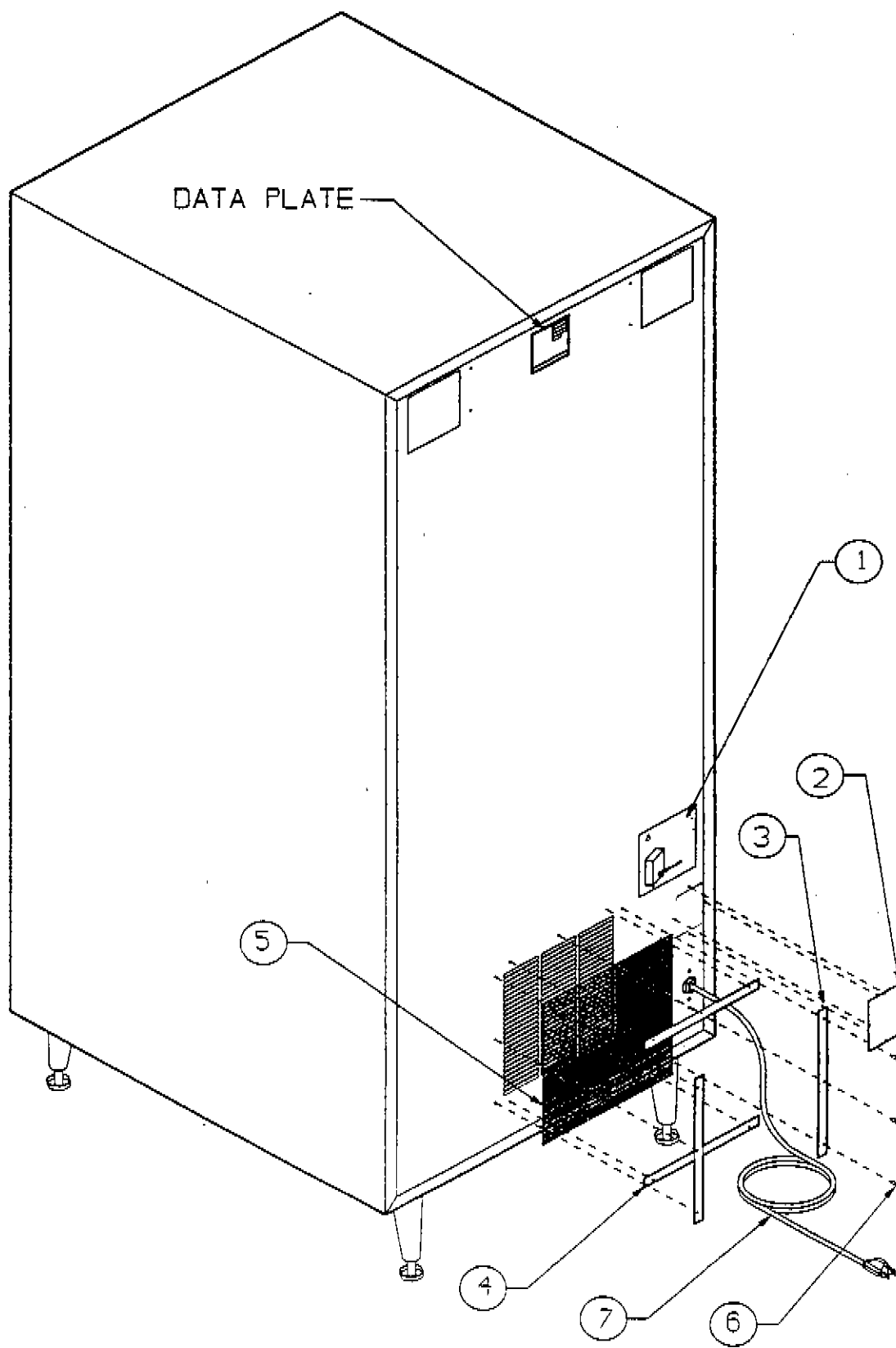

COOLING SYSTEM
PARTS LIST

TO BE USED IN CONJUNCTION WITH PAGES 51 AND 52 I

ITEM	DESCRIPTION	PART NO.	QTY
1	CHILLER BASE PLATE	23459	1
2	EVAPORATOR BASE PLATE	23432	1
3	CONDENSER FAN BRACKET	23493	1
4	CONDENSER BRACKET	23439	1
5	CONDENSATE PAN - CHILLER 134A	23434	1
6	EVAPORATOR DRAIN PAN	23451	1
7	HANDY BOX	098-8095	1
8	CONNECTOR	83692	1
9	MOUNTING BRACKET	23441	1
10	SCREW #8-32 X 3/8	01715	70
11	FAN AXIAL	098-8040	2
12	NUT HEX W/LOCKWASHER	20208	4
13	POWER CORD AND EVAP. FAN HARNESS	23611	1
14	DIVIDER INSULATION	23611	1
15	TOP INSULATION	23499	1
16	END INSULATION CHILLER	23610	1
17	END INSULATION	23539	1
18	COMPRESSOR	23487	1
19	SCREW HEX/WASHER HEAD 1/4-20 X 1 1/4	23494	4
20	TUBING ASSBLY-EVAPORATOR TO SERV. TEE	23464	1
21	TEE VALVE 1/4	098809801	1
22	TEE VALVE 3/8	098-8098	1
23	TUBING DRIER TO 1/4 SERVICE TEE	23445	1
24	FILTER DRIER	097-8000	1
25	TUBING-SERVICE TEE TO COMPRESSOR	23449	1
26	TUBING-COMPRESSOR TO CONDENSER	23443	1
27	TUBING CONDENSER TO DRIER	23444	1
28	DRAIN TUBE	23502	1
29	EXPANSION VALVE	097-8001	1
30	TUBING-EXPANSION VALVE TO EVAPORATOR	23447	1
31	EVAPORATOR	097-8003	1
32	THERMOSTAT	23506	1
33	TOP AND BACK - CHILLER	23489	1
34	HOUSING - CHILLER SIDES AND FRONT	23490	1
35	COMPRESSOR AND COND. FAN HARNESS	23510	1
36	EVAPORATOR FAN BRACKET	23630	1
37	CONDENSER	097-8007	1
38	THERMOSTAT MOUNTING PLATE	23440	1
39	CLIP	098-8144	2
40	NEOPRENE 3/32 X 1/2	1824500	39"
41	GASKET CHILLER TO CABINET	23520	53"
42	SCREW #6-32 X 5/16 ZINC PLATED	17691	3
43	FLAT WASHER	16154	4
44	HOLD DOWN BRACKET CONDENSATE PAN	23438	1
45	CHILLER SIDE COLD FOOD INSULATION	23498	1
46	DATAPLATE	23541	1
47	EVAPORATOR MOUNTING BRACKET	23491	1
48	GROMMET	23553	4
49	SLEEVE	23554	4
50	WIRING DIAGRAM DECAL	23555	1
51	COLD FOOD HANDLE	097-4128	1
52	EVAPORATOR BRACKET	23608	1
53	CHILLER BASE INSULATION	23613	1

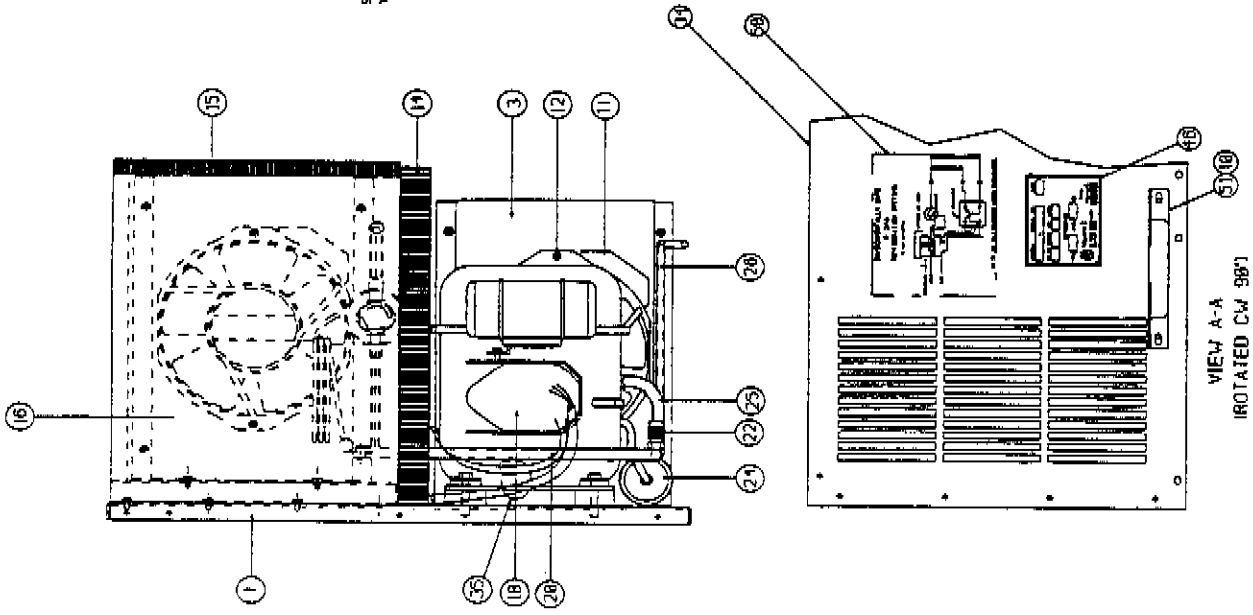
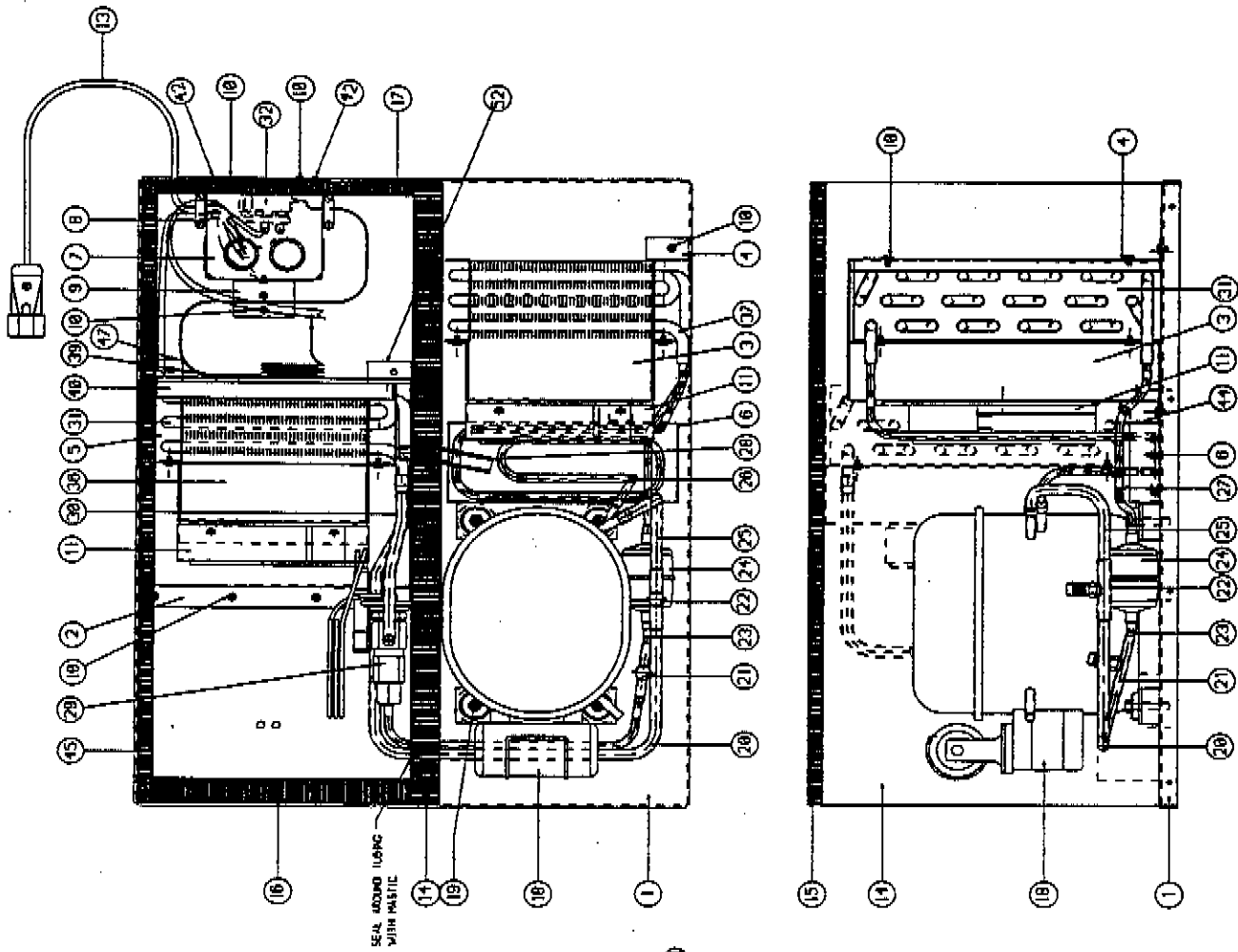

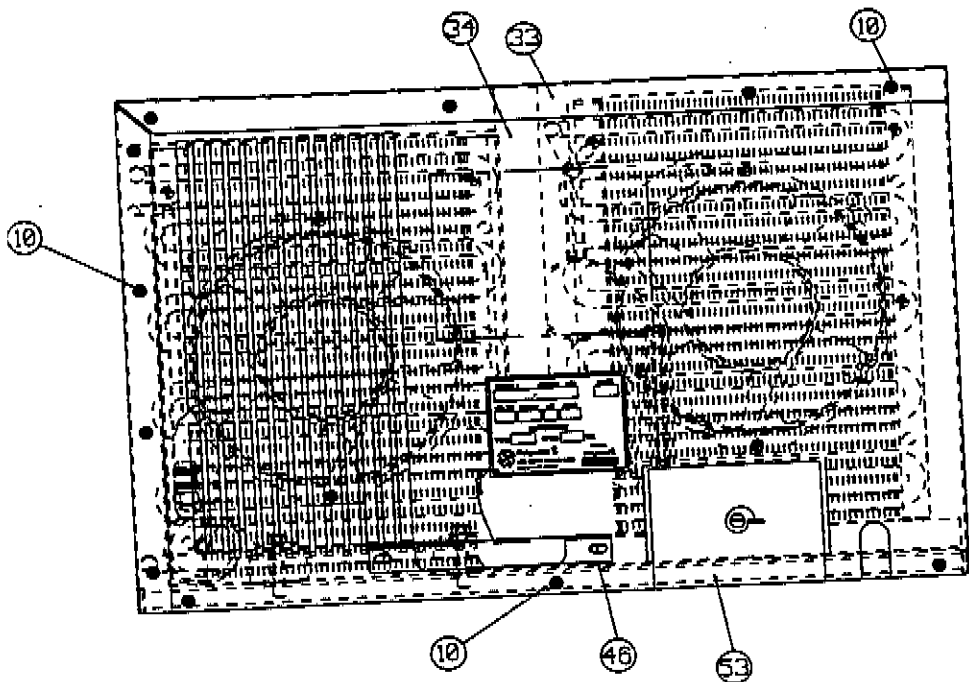

COMPRESSOR COMPONENT REPLACEMENT P/N

ITEM	PART NUMBER 115V-50HZ	PART NUMBER 238V-50HZ
CAPACITOR	23534	23537
RELAY	23533	23536
OVERLOAD	23532	23535

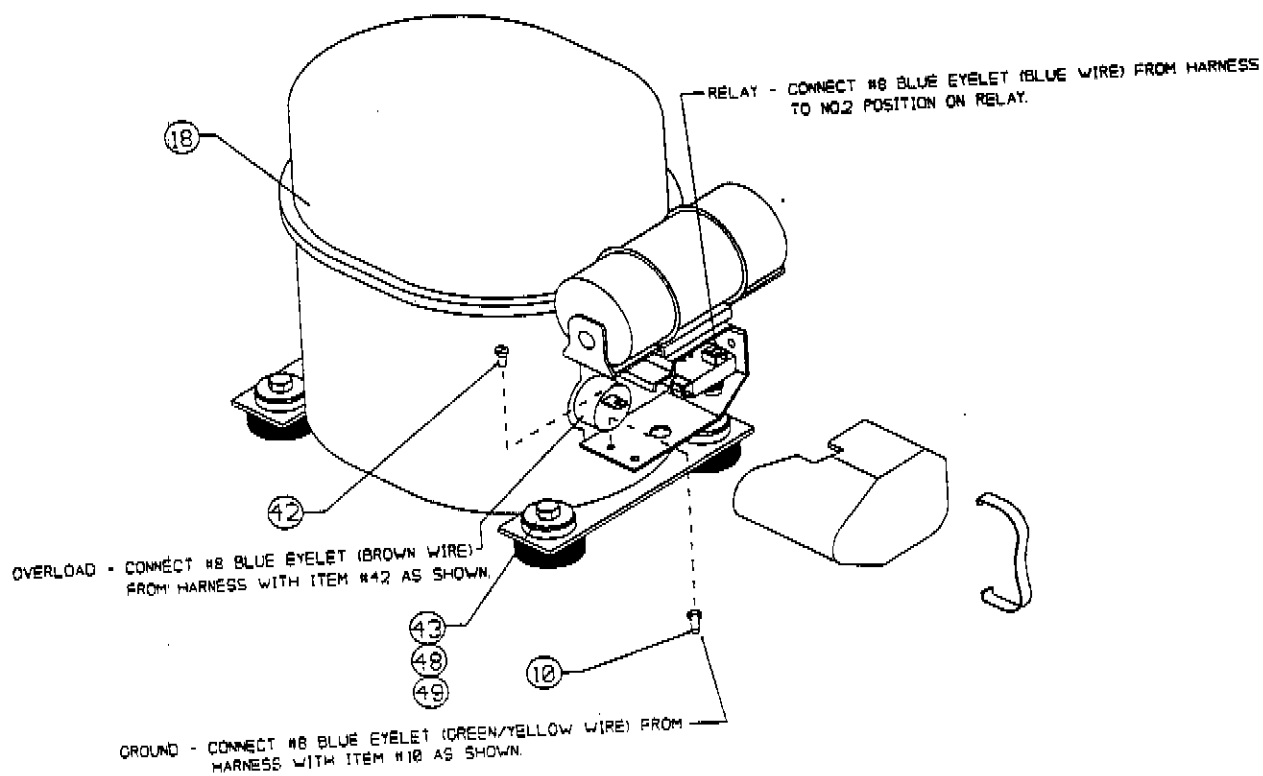

REFRIGERATED DOOR ASSEMBLY

TO BE USED IN CONJUNCTION WITH PAGES 54, 55 AND 56

ITEM	PART NUMBER	DESCRIPTION	QTY.
1	097-5022	DOOR AND FOAMING PANEL ASSEMBLY	1
2	097-4134	LOCK AND HANDLE-COLD FOOD	1
3	097-2000	TRACK - COLD FOOD DOOR	10
4	23346	VEND DOOR-COLD FOOD	9
5	098-9031	V-SEAL DOOR WEATHER STRIP	9
6	098-3016	DOOR STOP PRICE HOLDER	9
7	098-3017	PRICE TAG RETAINER	9
8	01715	SCREW, SEMS, #8-32 x 3/8"	4
9	097-8023	COLD FOOD DOOR SEAL	1
10	098-8044	NUMBER LABEL - H1 TO H10	1 ea.
11	097-8022	HINGE-INNER DOOR, COLD FOOD	2
12	098-4097	TRAY SHIELD - LOWER, WHITE	9
13	098-5089	VEND DOOR SPRING ASSEMBLY	9
14	098-4310	BRACKET, SWITCH MOUNTING	9
15	098-4311	SWITCH	9
16	200-8019	MICRO SWITCH	9
17	098-4087	SOLENOID BRACKET	9
18	098-6010	PIN - LOCK ARM	9
19	098-5043	LOCK ARM WELDMENT, BLACK	9
20	097-4056	SOLENOID COVER	1
21	22201	SPACER SLEEVE	1
22	098-4142	COLD FOOD DOOR SWITCH PLATE	1
23	220-8030	RIVET, BLIND, AD24ABS	2
24	099-8008	STUD, .125 PUSHNUT	18
25	098-7007	SPRING	9
26	010062-8	COTTER PIN	9
27	098-5081	SOLENIOD - DIODE BOARD ASSEMBLY	9
28	18370BLK	SCREW, #6 x 3/16, TAPPING, B	18
29	04455	SCREW, #4-40 x 5/8	18
30	20208	NUT WITH LOCKWASHER, #8-32	54
31	098-4025	SPRING BRACKET, VEND DOOR, BLACK	9
32	099-6000	SHAFT, SPRING ROLLER, GUM AND MINT	9
33	099-3002	ROLLER, GUM AND MINT SPRING	9
34	19165	SPRING, CONSTANT FORCE	9
35	05372	SCREW, #10-24	1
36	15987	NUT, HEX, #4-40 STEEL	18
37	5471032-10	FLAT HEAD SOCKET CAP SCREW, 10-32 x 5/8	12
38	S10D632-14	SCREW, #6-32 x 7/8, 6087MXRS	30
39	098-8025	KOREL TAPE	4 Ft.
40	20102	STRIPPING, VINYL, 1/2" x 1/2"	.386 ft.
41	097-5082	HARNESS-DOOR SOLENOID FEED	1
42	098-5269	HARNESS, JUMPER - T D SWITCH	9
43	097-5083	HARNESS-DOOR INTERLOCK SWITCHES	1
44	098-6012	INNER GUARD BUSHING	6
45	097-4111	BRACKET-DOOR LATCH	1
46	23552	NUT, HEX, NYLOCK, #10-24	1

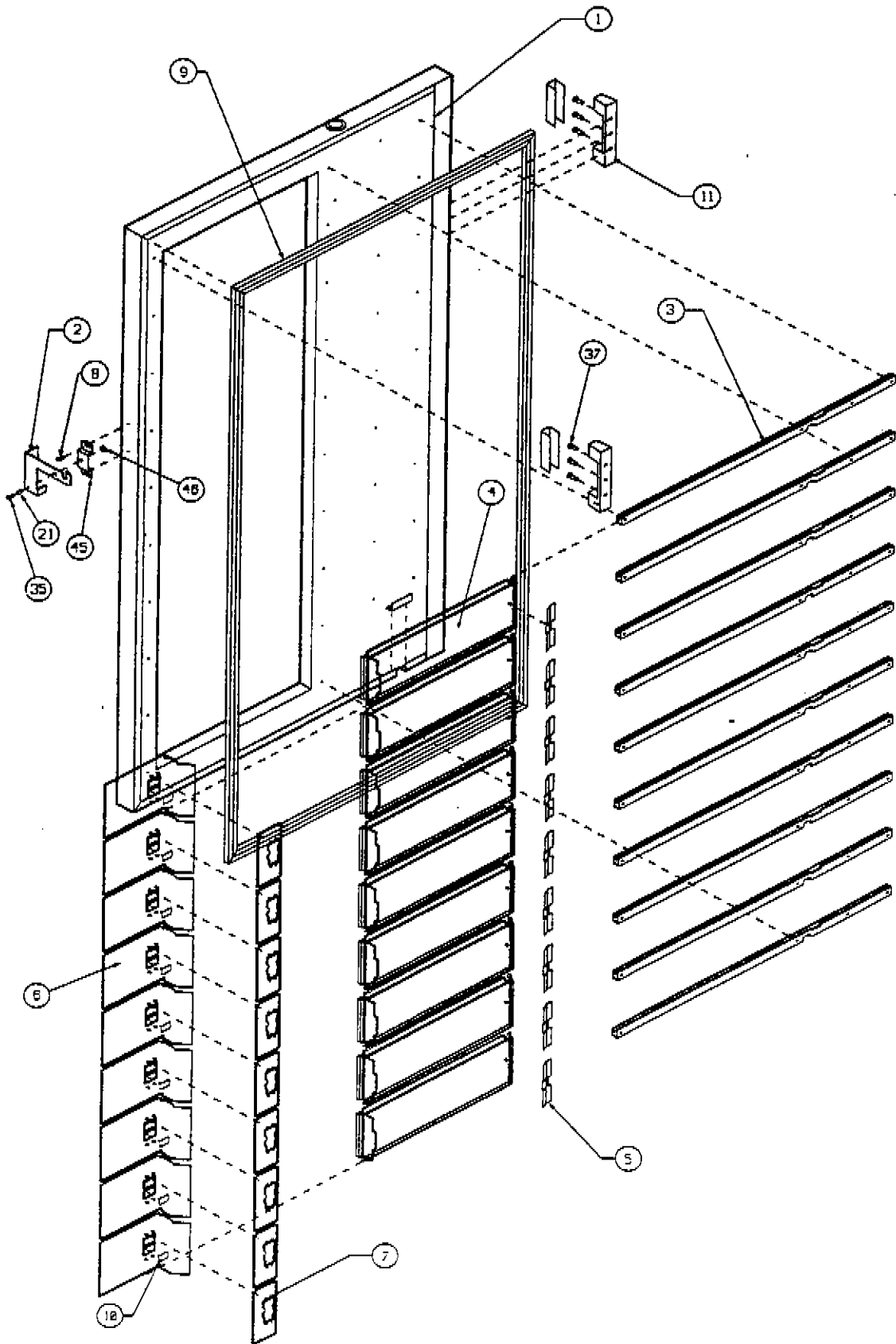

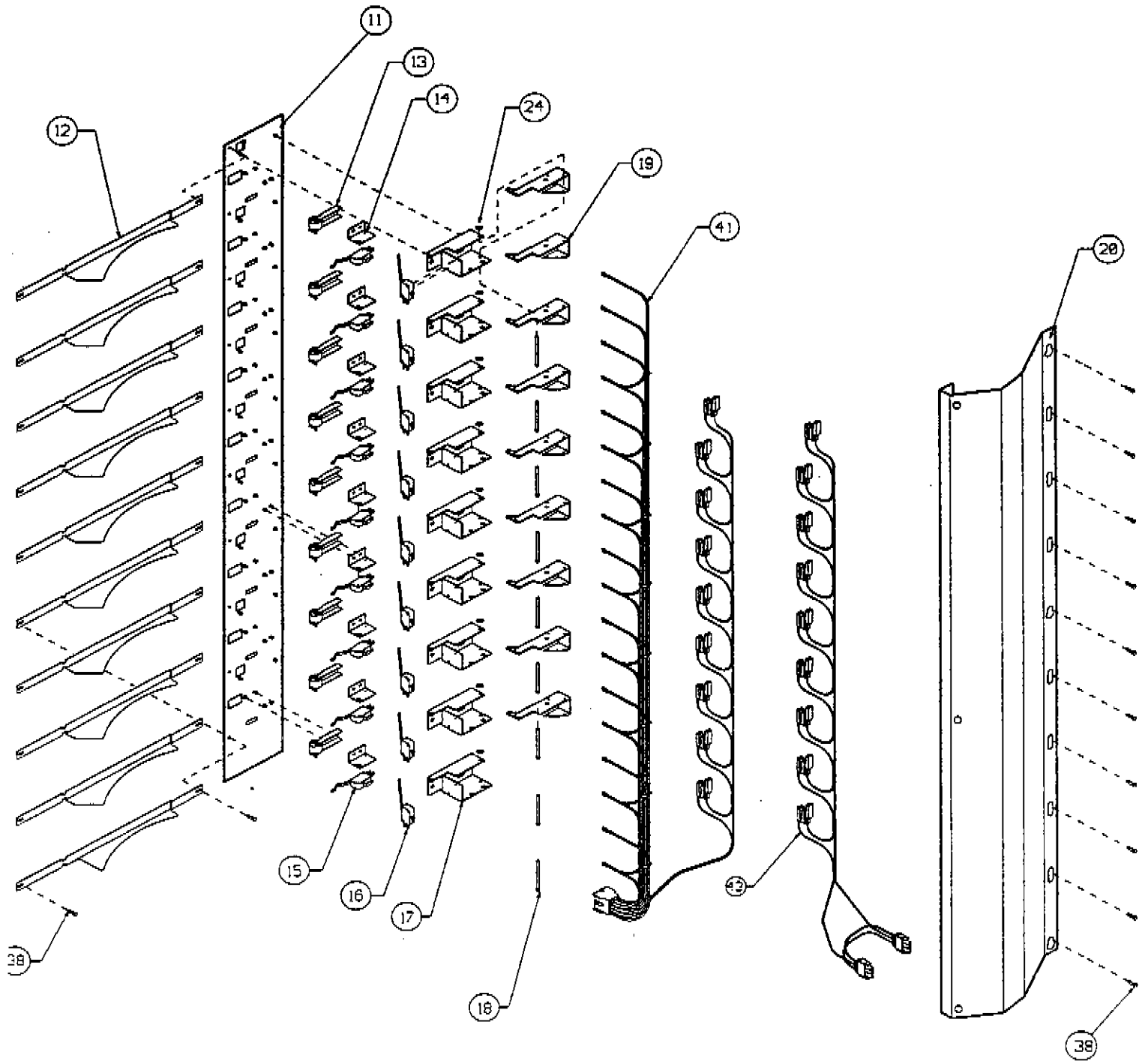

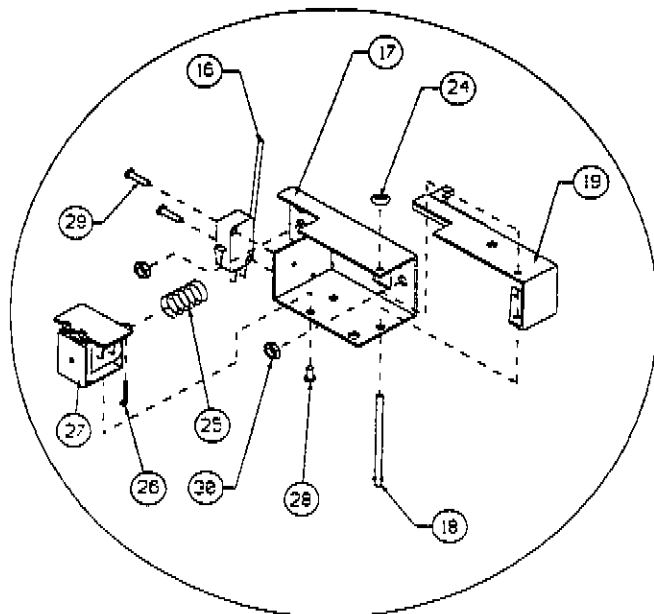
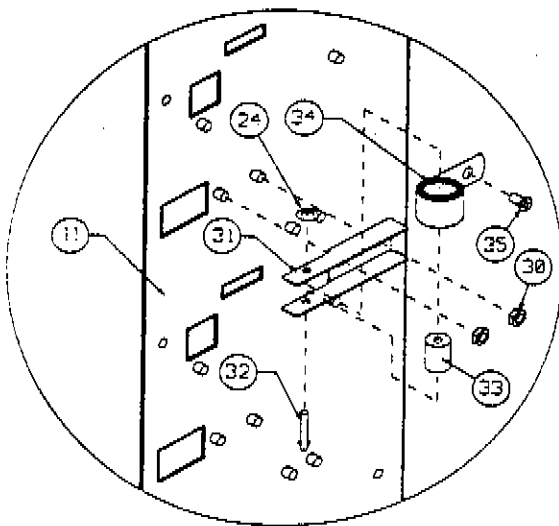
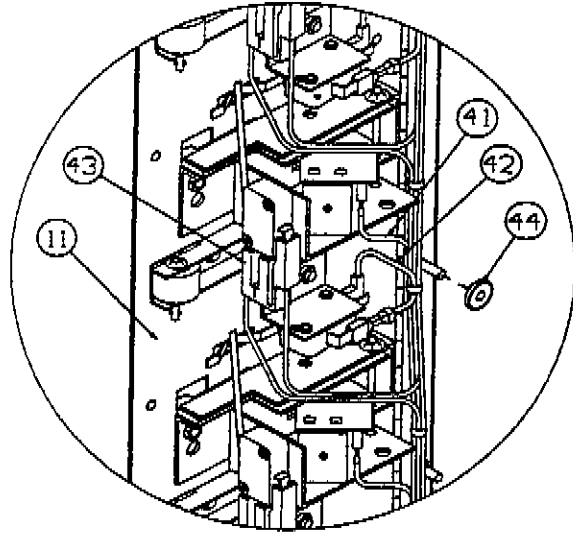
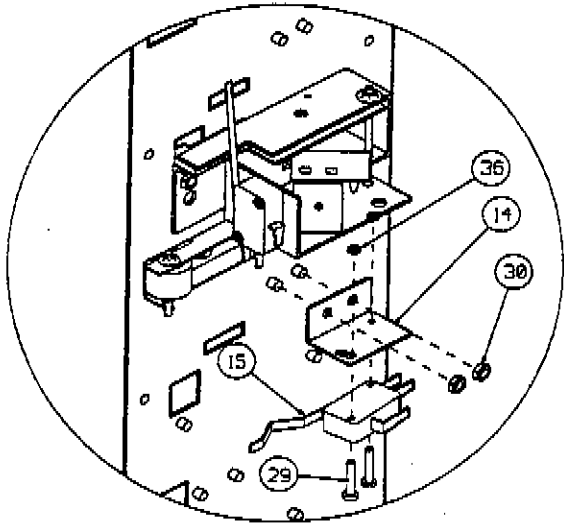

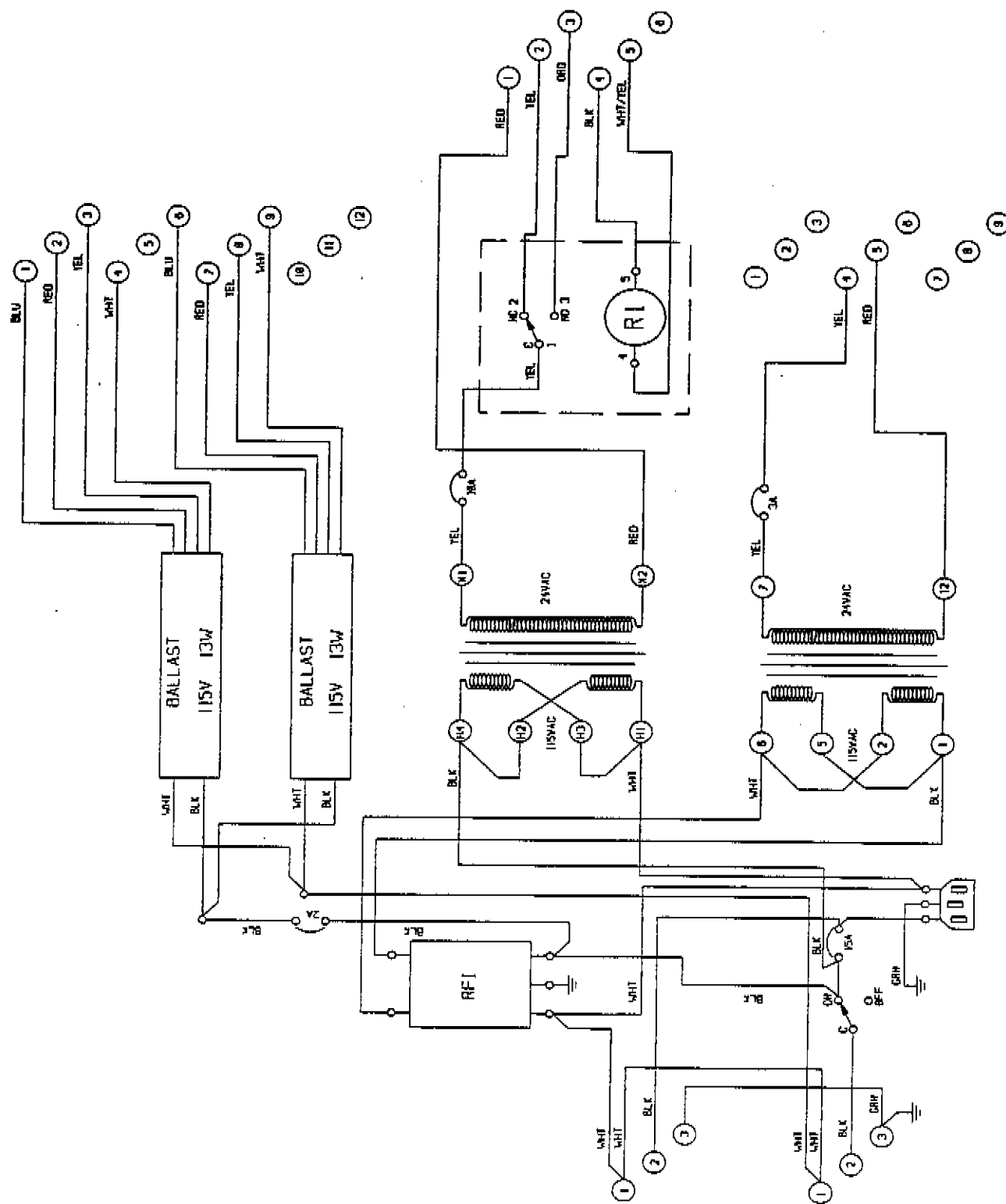

POWER BOX SCHEMATIC

**POWER BOX ASSEMBLY
PARTS LIST**

ITEM	DESCRIPTION	PART NO.	QTY
1	POWER BOX ASSEMBLY	097-5069	1
2	9 CIRCUIT HOUSING	210-8007	1
3	AUXILIARY OUTLET	19663	1
4	CONTROLLER TRANSFORMER ASSY.	097-5096	1
5	RFI FILTER	20758	1
6	POWER BOX SIDE	097-4098	1
7	DUAL BALLAST ASSEMBLY	097-5095	1
8	SHOPPER RELAY ASSEMBLY	097-5094	1
9	SCREW #6-20 X 1/4	S39C620-4	1
10	POWER INPUT HARNESS	097-5092	1
11	3 CIRCUIT HOUSING	097-8038	1
12	POWER SWITCH	20166	1
13	SHOPPER TRANSFORMER ASSEMBLY	097-5093	1
14	GROUND HARNESS	097-5101	2
15	2 AMP. CIRCUIT BREAKER	2233001	1
16	3 AMP. CIRCUIT BREAKER	2233002	1
17	10 AMP. CIRCUIT BREAKER	2233004	1
18	15 AMP. CIRCUIT BREAKER	2233005	1
19	BALLAST FEED HARNESS	097-5097	1
21	24 VAC OUTPUT HARNESS	097-5099	1
22	SWITCH OUTPUT HARNESS	097-5100	1
23	POWER BOX COVER	097-4122	1
24	SCREW #8-32 X 5/16	01715	18
25	HEX NUT #8-32	20208	2
26	SCREW #8-18 X 5/16	01298BLK	2

